

PERIMETER SILT FENCE OR FIBER ROLLS

BACKYARD DRAINAGE SWALE

NOTE:  
PERMIMETER SILT FENCE OR FIBER ROLLS WILL BE REQUIRED ONLY WHERE THE ADJACENT AREA OR LOT HAS BEEN GRADED, SODDED OR SEEDED.

ALL SILT FENCE OR FIBER ROLLS SHOULD TERMINATE WITH J-HOOKS.

IF A PERMANENT DRIVEWAY IS IN PLACE IT MAY BE USED IN PLACE OF A SECONDARY CONSTRUCTION ENTRANCE.

IF A GRASS BUFFER STRIP IS MISSING OR DAMAGED, USE SILT FENCE OR FIBER ROLL AS NEEDED TO CREATE CONTINUOUS LINE OF PROTECTION AT BACK OF CURB.

PLACE AND MAINTAIN INLET PROTECTION AT DOWNSTREAM CATCH BASINS.

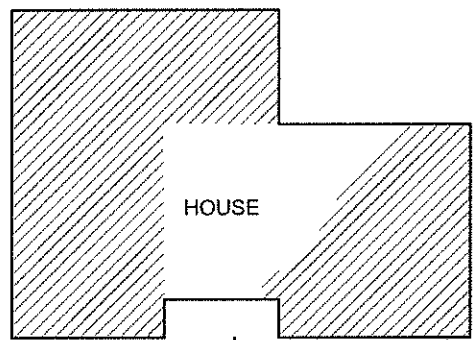
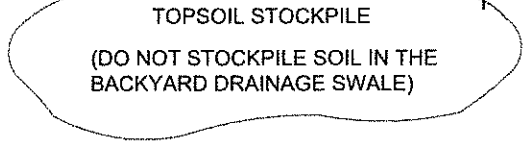

PROPERTY LINE



SECONDARY CONSTRUCTION ENTRANCE (LOCATION MAY VARY)

DRIVEWAY SHALL BE USED AS THE PRIMARY CONSTRUCTION ENTRANCE AND SHALL BE PAVED OR GRAVEL

TEMPORARY SILT FENCE OR FIBER ROLL (AS NEEDED)

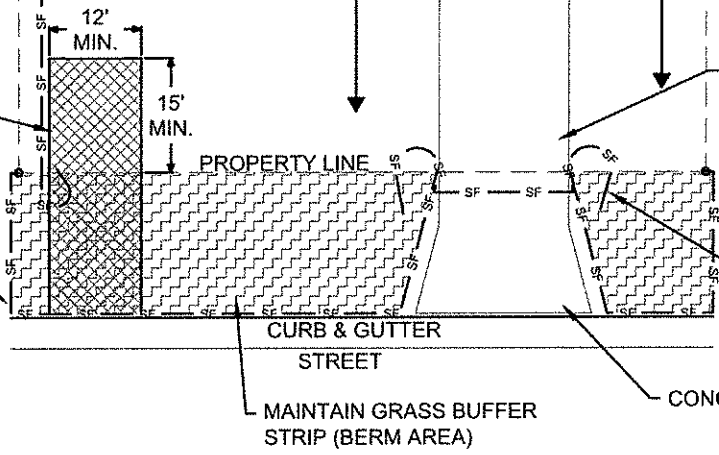
SILT FENCE OR FIBER ROLL (AS NEEDED)

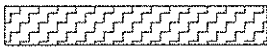

- SF — SF — SF — SF — SILT FENCE OR FIBER ROLLS
-  SECONDARY CONSTRUCTION ENTRANCE
-  DIRECTION OF SURFACE WATER RUNOFF
-  GRASS BUFFER STRIP
- - - - - PROPERTY LINE

NOTE:  
TEMPORARY FENCING MY BE NECESSARY TO PREVENT DAMAGE TO GRASS STRIP ON THE BERM



CITY OF  
GRAND FORKS  
ENGINEERING  
DEPARTMENT

TYPICAL SINGLE FAMILY LOT EROSION CONTROL PLAN

DATE  
3/15/2018

CITY PROJECT  
N/A

SCALE  
NTS

PAGE  
1 of 1

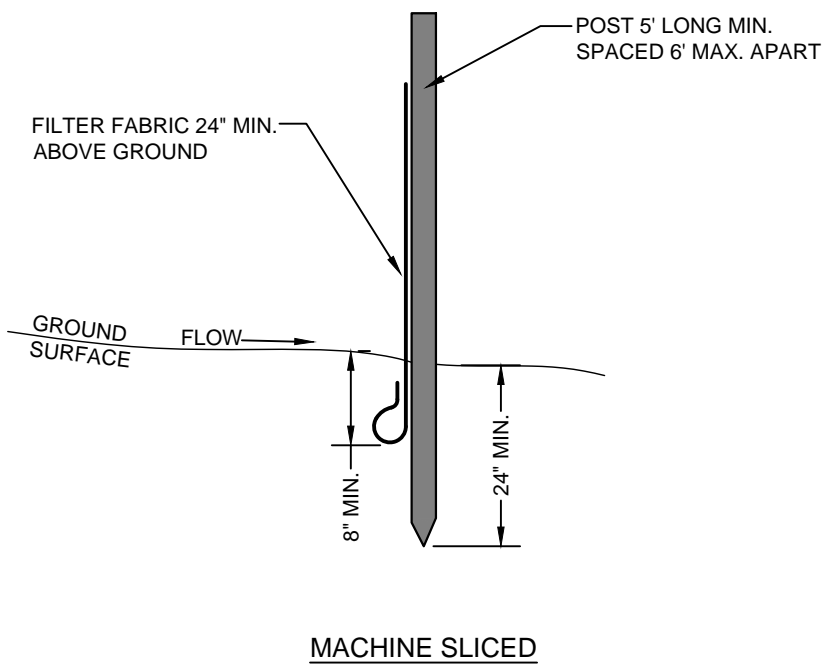
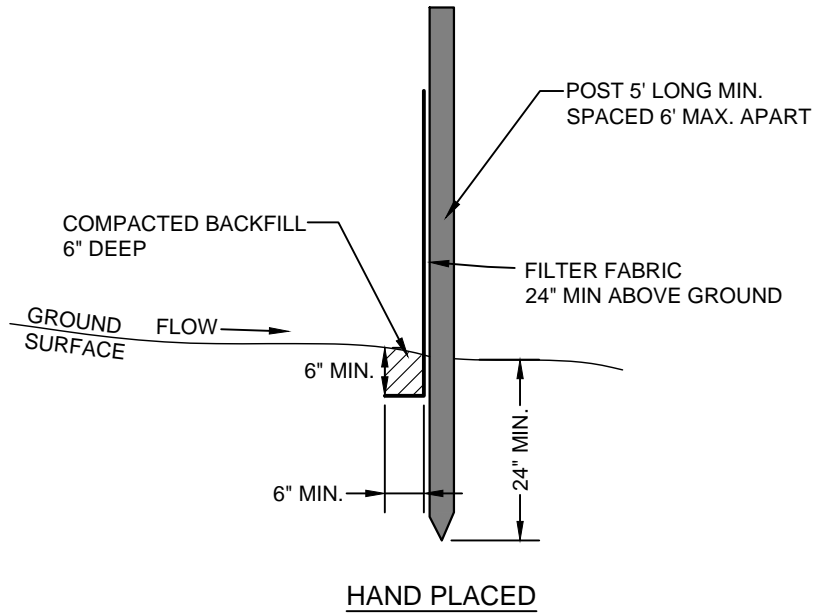

ALL SILT FENCE SHALL BE PROPEX  
2127 OR GEOTEX 915SC  
(OR APPROVED EQUAL)

P:\AutoCAD Libraries\Standard Plates\DWGs\SP69.02.dwg.dwg

	DATE: 3/28/15	<h1>SILT FENCE</h1>	CITY ENGINEER ALLEN GRASSER	DRAWN BY: MPY
			SCALE: NTS	STD. PLATE 69.02

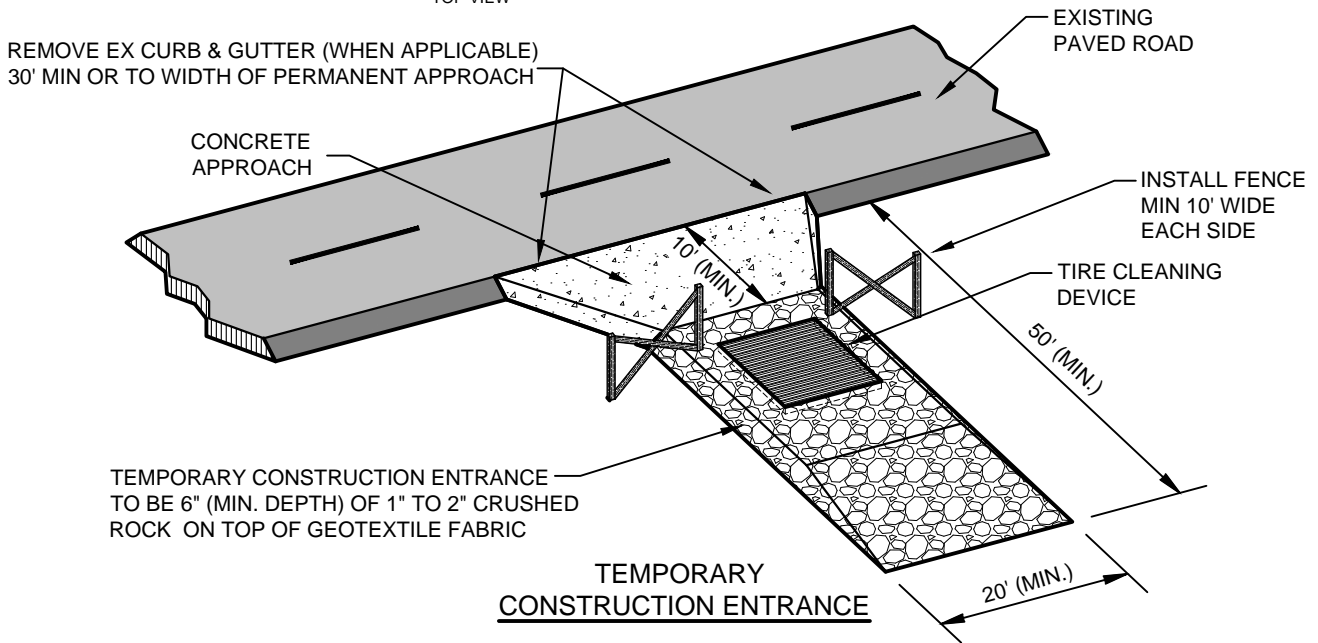
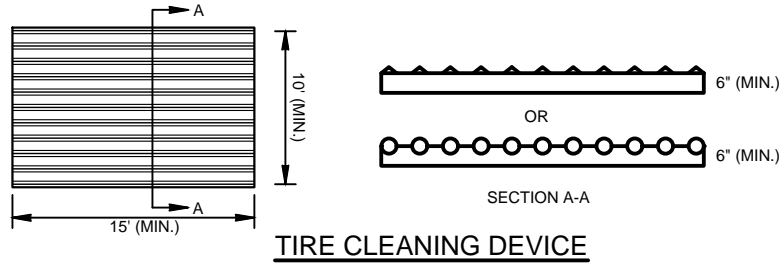
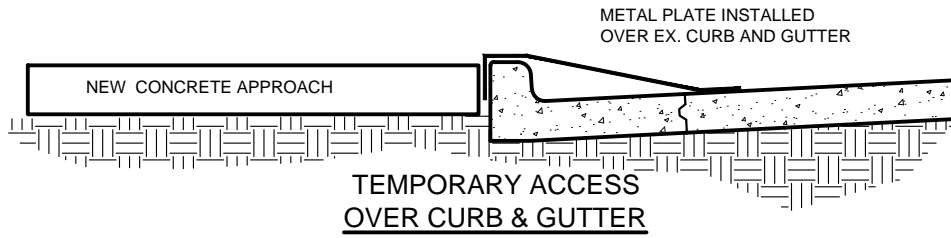

**NOTES:**

1. THE LOCATION OF CONSTRUCTION ENTRANCES SHALL BE AS SHOWN ON THE PLANS AND SHALL COINCIDE WITH THE PERMANENT ACCESS. IF THIS IS NOT PRACTICAL, THE CONTRACTOR SHALL COORDINATE THE LOCATIONS WITH THE ENGINEER.
2. EXISTING CURB AND GUTTER SHALL BE REMOVED AND A CONCRETE APPROACH SHALL BE INSTALLED AS SHOWN. CONCRETE APPROACH MAY BE TEMPORARY OR INSTALLED AS THE PERMANENT APPROACH TO THE SITE. APPROACH SHALL BE SLOPED TO MATCH PROPOSED SITE GRADES OR MINIMUM 2% TOWARDS EXISTING STREET. METAL PLATE MAY BE INSTALLED TO BRIDGE CURB & GUTTER IN LIEU OF C&G REMOVAL IF NO PERMANENT APPROACH IS TO BE INSTALLED.
3. UPON COMPLETION OF THE PROJECT, THE CONTRACTOR SHALL REMOVE THE TEMPORARY CONSTRUCTION ENTRANCE UNLESS NOTED OTHERWISE, AND THE SITE SHALL BE RESTORED TO ITS PREVIOUS CONDITION.
4. ENTRANCES SHALL BE MAINTAINED IN A MANNER TO MINIMIZE THE TRACKING OF SEDIMENT ONTO PAVED SURFACES.
5. FENCE SHALL BE INSTALLED ON EACH SIDE OF TIRE CLEANING DEVICE, SPACED TO FORCE TRAFFIC OVER DEVICE. FENCE POSTS SHALL BE METAL OR 4x4 WOOD, MINIMUM 4' TALL.

P:\AutoCAD Libraries\Standard Plates\DWGs\SP69.03.dwg.dwg



DATE:  
3/28/15

## TEMPORARY CONSTRUCTION ENTRANCE

CITY ENGINEER  
ALLEN GRASSER

SCALE:  
NTS

DRAWN BY:  
RJL

STD. PLATE  
69.03

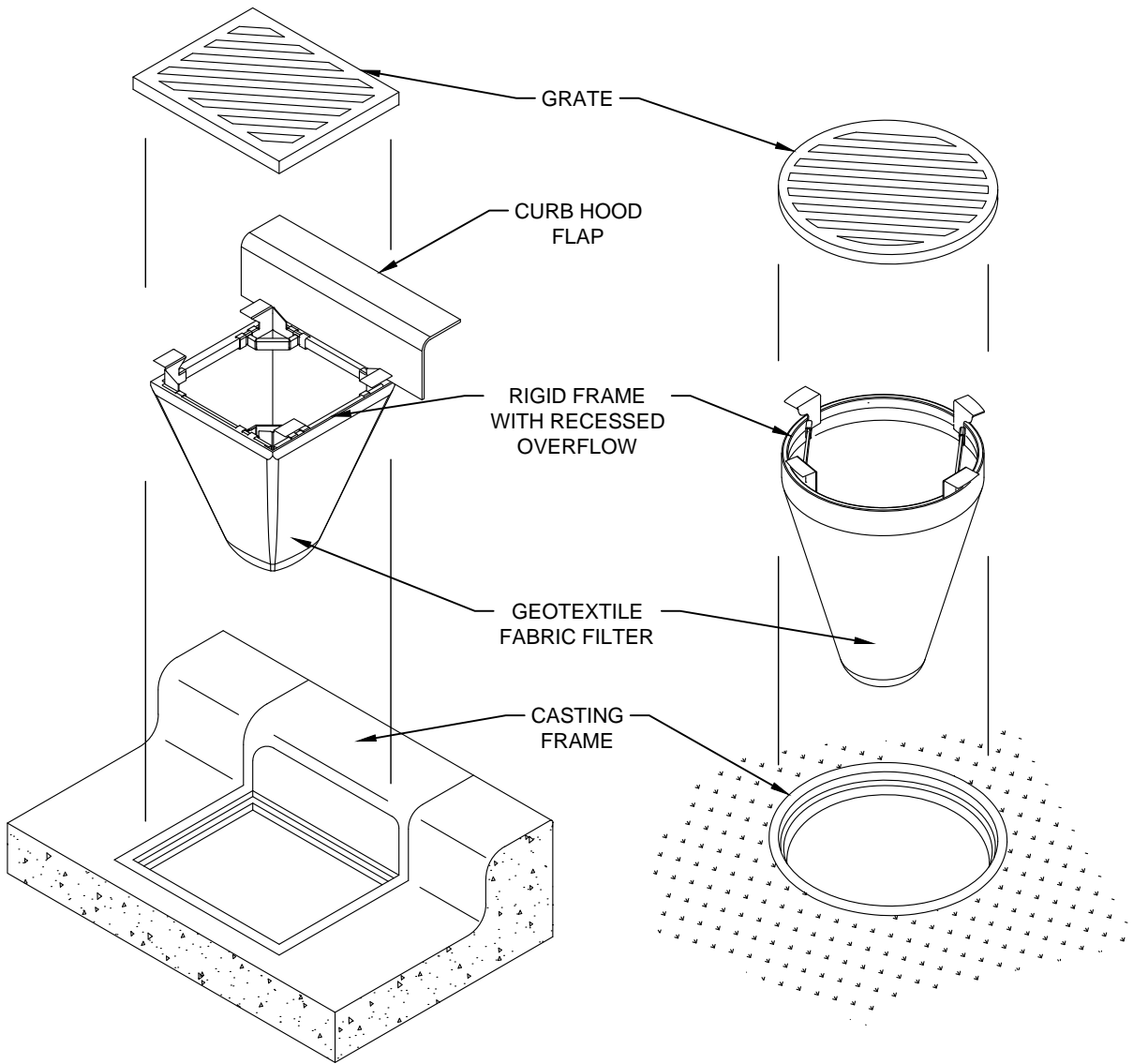

CATCH BASIN

AREA DRAIN

**NOTES:**

1. INLET PROTECTION DEVICE SHALL BE MANUFACTURED TO BE RECESSED WITHIN SPECIFIED OR EXISTING CASTING.
2. OVERFLOW TO BE SIZED AT A MINIMUM TO ACCOMMODATE THE GRATE FLOW CAPACITY.

P:\AutoCAD Libraries\Standard Plates\DWGs\SP69.04.dwg.dwg

	DATE: 2/13/17	<h1>INLET PROTECTION</h1>	CITY ENGINEER ALLEN GRASSER	DRAWN BY: MPY
			SCALE: NTS	STD. PLATE 69.04

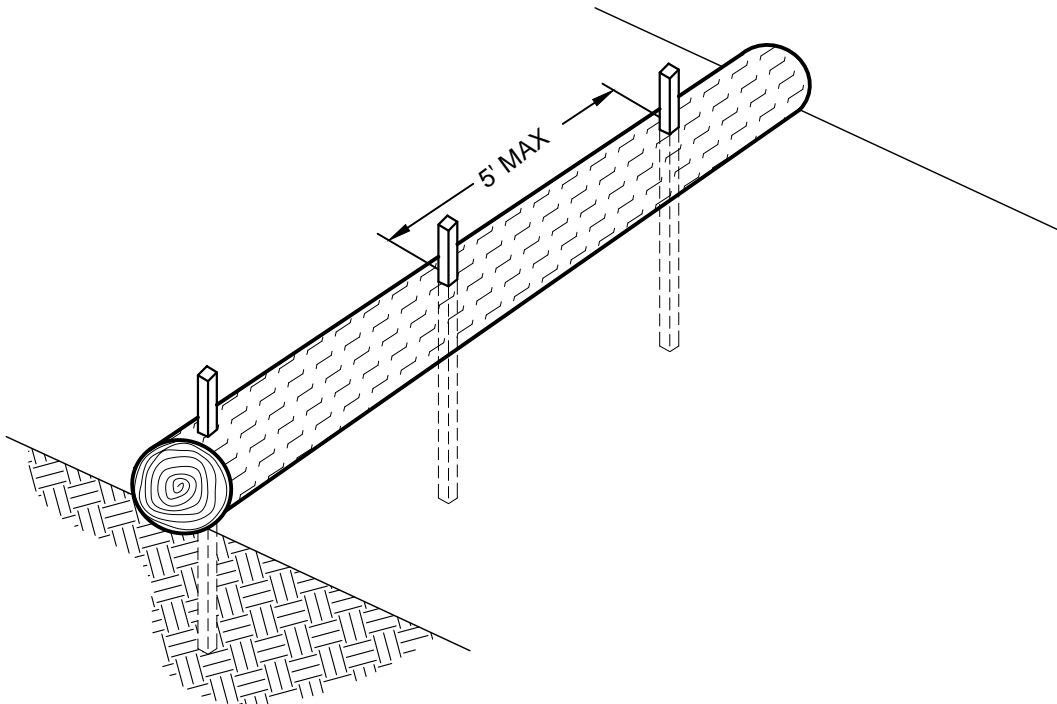
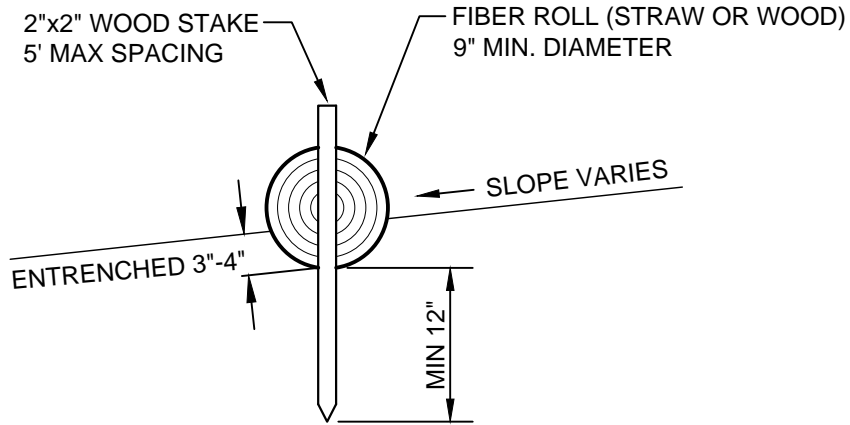

**NOTE:**

1. WHEN INSTALLING IT IS IMPORTANT NOT TO CRUSH FIBER ROLL.

P:\AutoCAD Libraries\Standard Plates\DWGs\SP69.05.dwg.dwg

	DATE: 3/28/15	<h1>FIBER ROLL</h1>	CITY ENGINEER ALLEN GRASSER	DRAWN BY: MPY
			SCALE: NTS	STD. PLATE 69.05

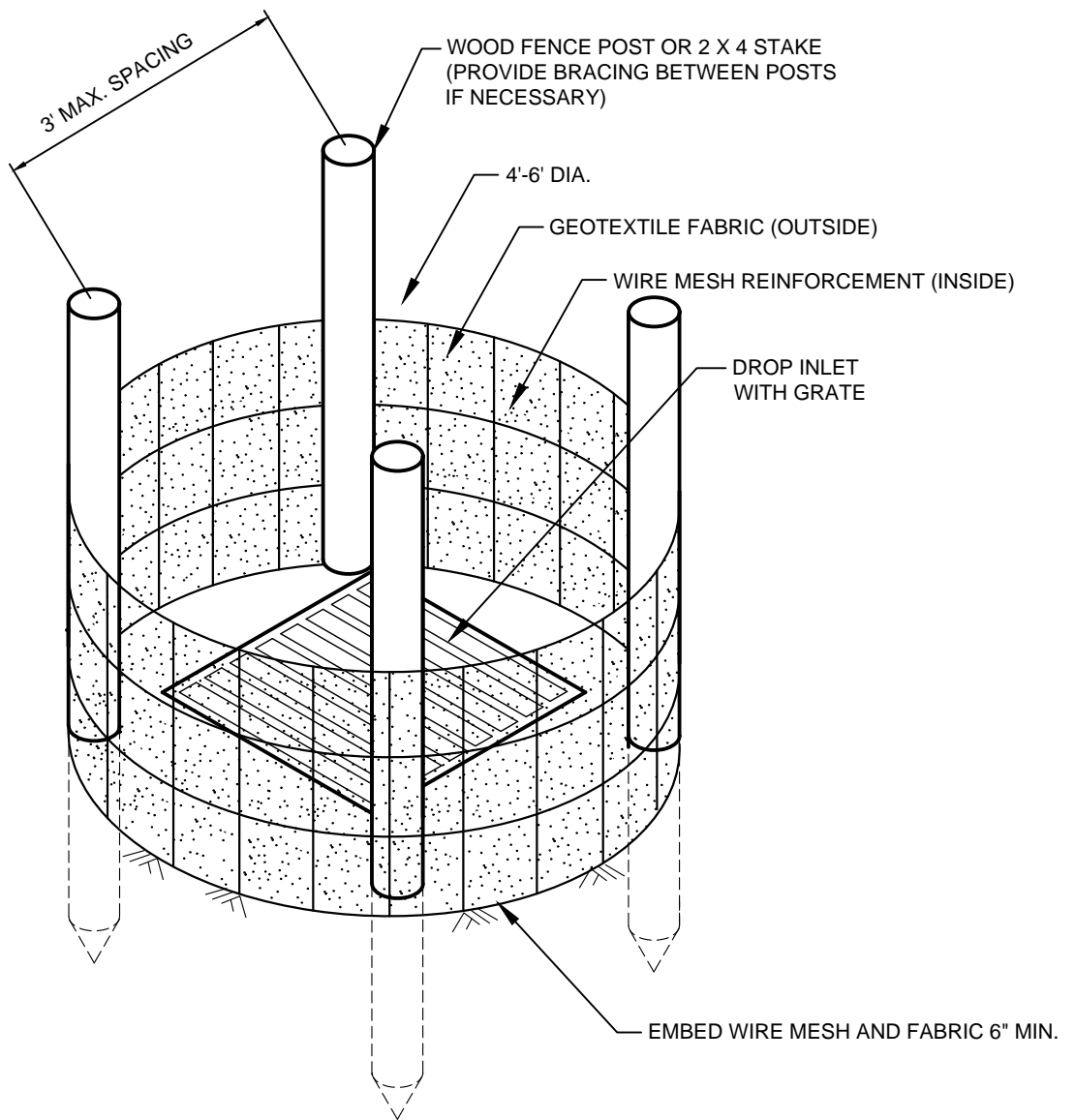

**NOTES:**

1. INLET PROTECTION DEVICES SHALL BE MAINTAINED OR REPLACED AT THE DIRECTION OF THE ENGINEER.
2. MANUFACTURED ALTERNATIVES MAY BE SUBSTITUTED, SUBJECT TO THE ENGINEER'S APPROVAL.
3. WHEN REMOVING OR MAINTAINING INLET PROTECTION, CARE SHALL BE TAKEN SO THAT THE SEDIMENT TRAPPED ON THE GEOTEXTILE FABRIC DOES NOT FALL INTO THE INLET. ANY MATERIAL FALLING INTO THE INLET SHALL BE REMOVED IMMEDIATELY.

**AREA DRAIN INLET PROTECTION TYPE 1**  
3/28/15 PLATE 69.06

P:\AutoCAD Libraries\Standard Plates\DWGs\SP69.06.dwg

	DATE: 3/28/15	<h2 style="margin: 0;">AREA DRAIN INLET PROTECTION TYPE 1</h2>	CITY ENGINEER ALLEN GRASSER	DRAWN BY: MPY
			SCALE: NTS	STD. PLATE 69.06

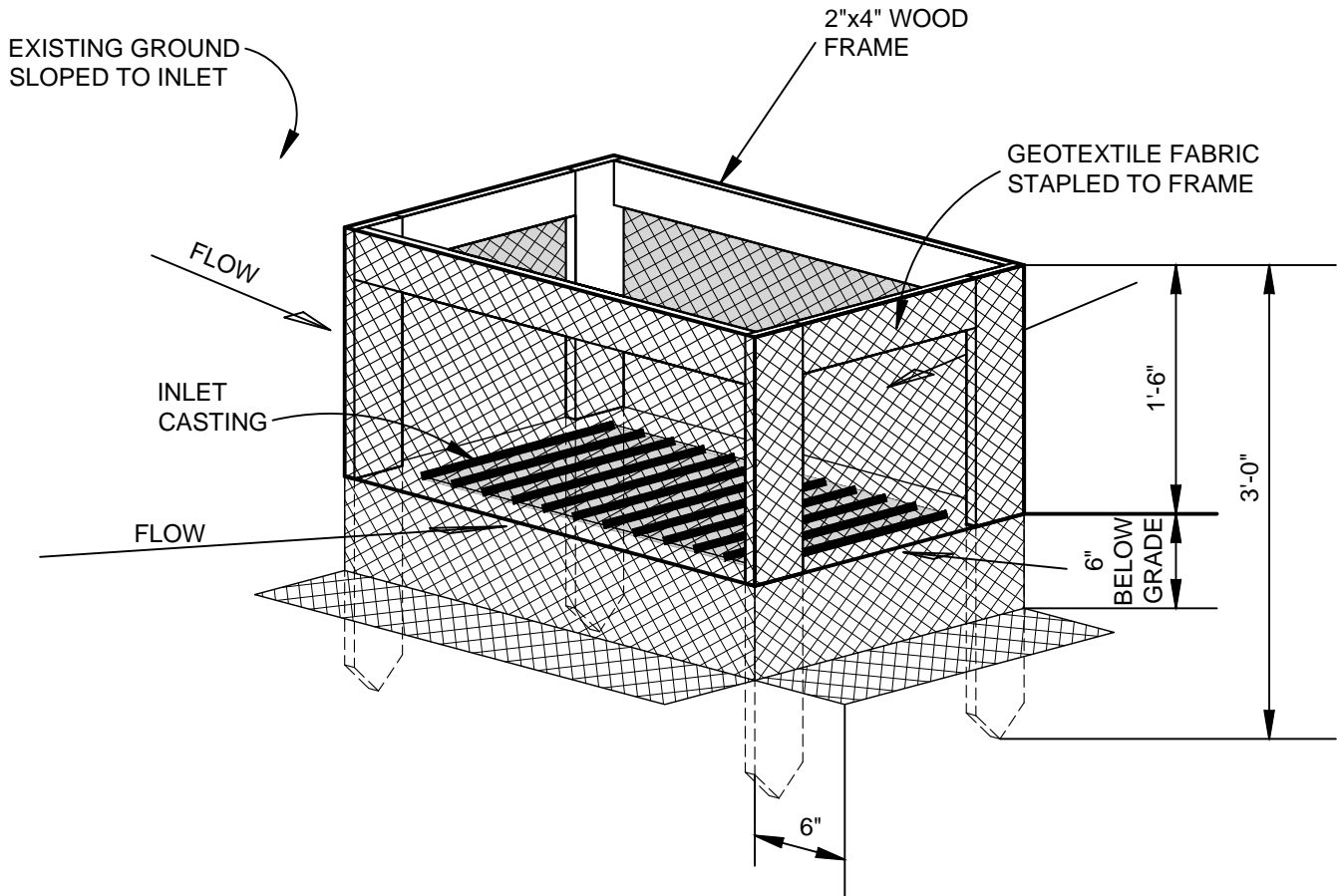

**NOTES:**

1. PREMANUFACTURED FRAMES MAY BE USED INSTEAD OF CONSTRUCTING WOOD FRAMES, PROVIDING THAT ADEQUATE SUPPORT FOR THE GEOTEXTILE FABRIC IS PROVIDED.

P:\AutoCAD Libraries\Standard Plates\DWGs\SP69.06Adwg.dwg

 <p>ENGINEERING DEPARTMENT</p>	DATE: 3/28/15	<h2>AREA DRAIN INLET PROTECTION TYPE 2</h2>	CITY ENGINEER ALLEN GRASSER	DRAWN BY: MPY
			SCALE: NTS	STD. PLATE 69.06A

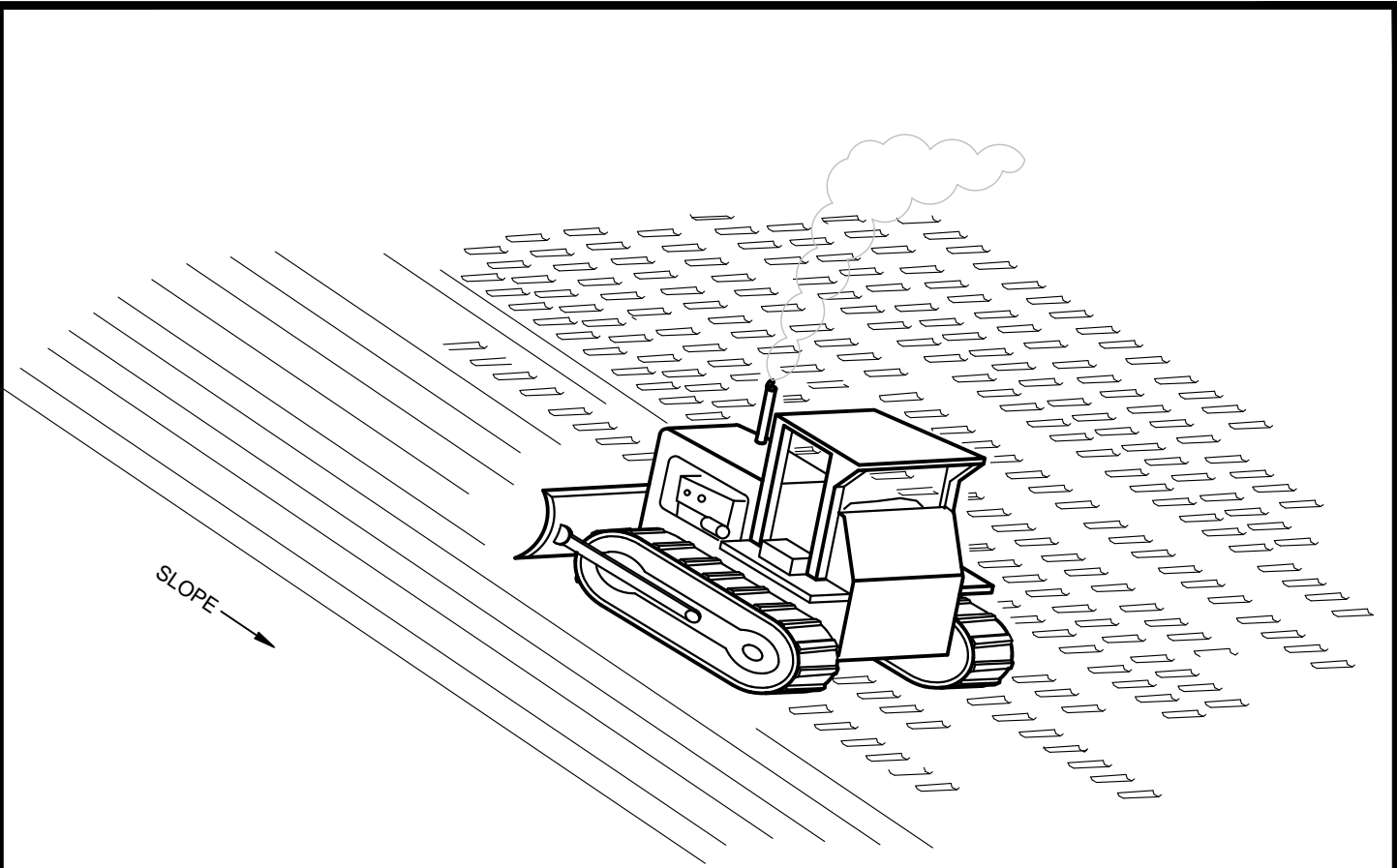

**NOTES:**

1. 'TRACKING' WITH MACHINERY UP AND DOWN THE SLOPE SHALL BE DONE PARALLEL TO THE SLOPE TO MINIMIZE EROSION DUE TO RAINFALL RUN-OFF.
2. ALL DISTURBED AND NEWLY CONSTRUCTED SLOPES SHALL BE 'TRACKED' IMMEDIATELY UPON SLOPE CONSTRUCTION PRIOR TO TURF RESTORATION.

P:\AutoCAD Libraries\Standard Plates\DWGs\SP69.07.dwg.dwg

	DATE: 3/28/15	<h2 style="margin: 0;">SURFACE ROUGHENING</h2>	CITY ENGINEER ALLEN GRASSER	DRAWN BY: MPY
			SCALE: NTS	STD. PLATE 69.07



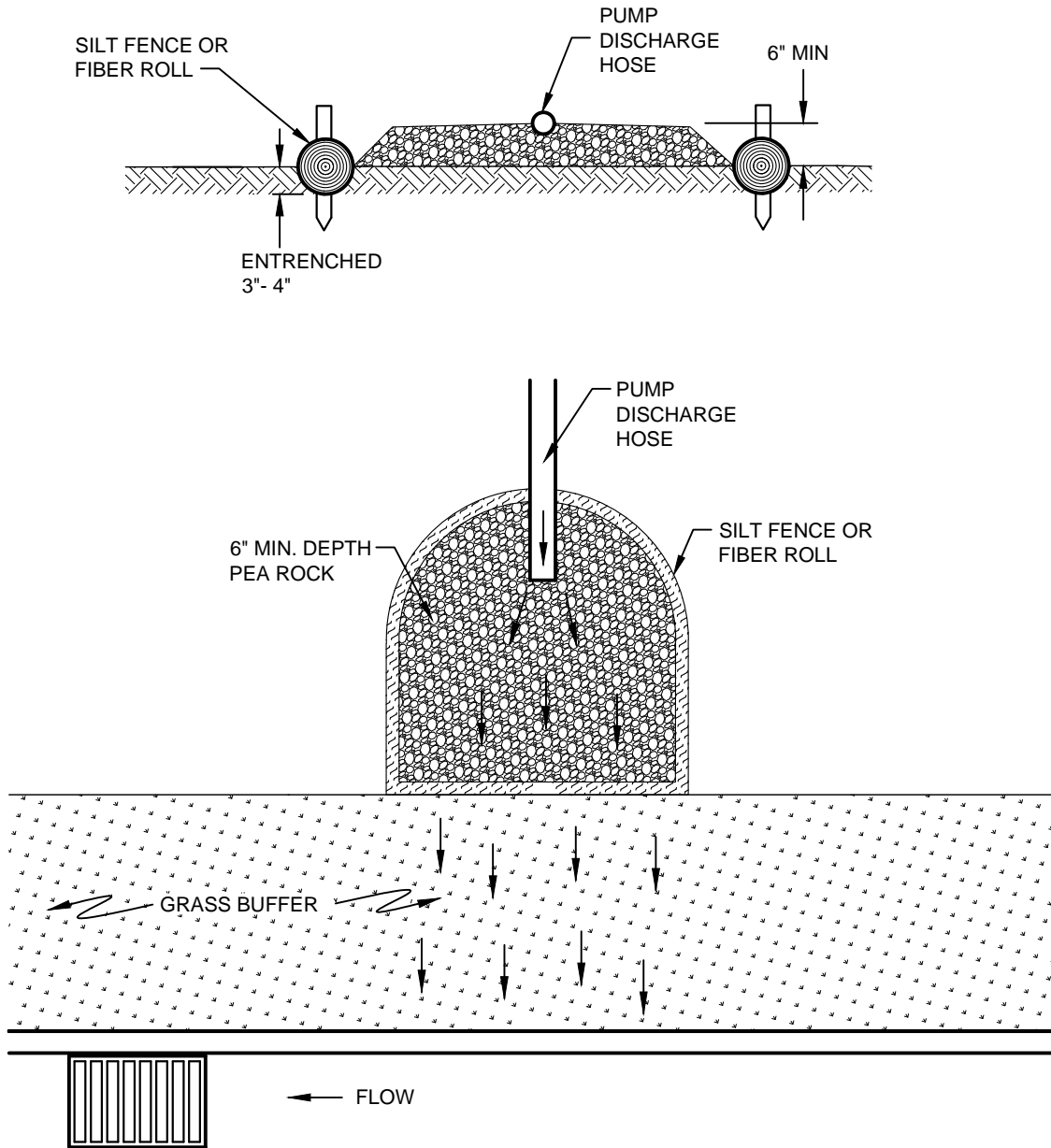

**NOTES:**

1. DISCHARGE WATER ONTO A GRASS BUFFER.
2. DISCHARGE WATER MUST FLOW AWAY FROM CONSTRUCTION AREA.
3. THE PEA ROCK MAY BE PLACED ON GRASS OR ENGINEERING FABRIC MAY BE USED. DEWATERING STRUCTURE SHALL NOT BE PLACED ON BARE SOIL.
4. THE CAPACITY OF THE STRUCTURE SHALL BE ADEQUATE TO HANDLE THE DEWATERING PUMP DISCHARGE.

P:\AutoCAD Libraries\Standard Plates\DWGs\SP69.08.dwg.dwg

 <p>ENGINEERING DEPARTMENT</p>	DATE: 3/28/15	<h2>AGGREGATE FILTER DEWATERING</h2>	CITY ENGINEER ALLEN GRASSER	DRAWN BY: MPY
			SCALE: NTS	STD. PLATE 69.08

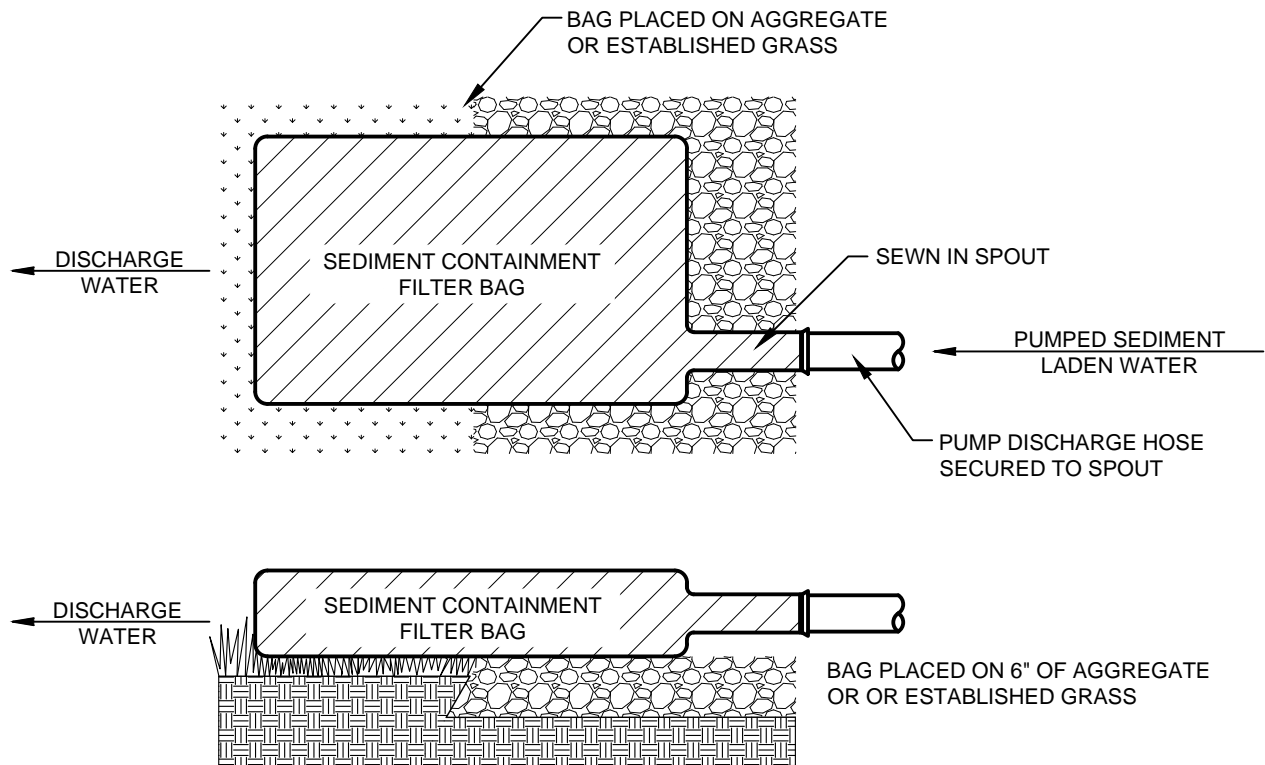

**SEDIMENT FILTER BAG**

**NOTES:**

1. DISCHARGE WATER ONTO A GRASS BUFFER.
2. DISCHARGE WATER MUST FLOW AWAY FROM THE CONSTRUCTION AREA.
3. SEDIMENT CAPTURED BY THE FILTER BAG MUST BE REMOVED AND STABILIZED.
4. THE FILTER BAG SHOULD BE CONSTRUCTED OF NON-WOVEN GEOTEXTILE MATERIAL THAT WILL PROVIDE ADEQUATE FILTERING ABILITY TO CAPTURE THE LARGER SOIL PARTICLES FROM THE PUMPED WATER.
5. THE BAG MAY BE PLACED ON WELL ESTABLISHED GRASS OR 6" MINIMUM OF AGGREGATE. FILTER BAG SHALL NOT BE PLACED ON BARE SOIL.
6. THE CAPACITY OF THE FILTER BAG SHALL BE ADEQUATE TO HANDLE THE DEWATERING PUMP DISCHARGE, AND SHOULD BE BASED ON THE BAG MFG.'S RECOMMENDATION.
7. WHEN USED IN CONJUNCTION WITH A STRAW BALE/SILT FENCE PIT, A FILTER BAG MAY BE OPERATED UNTIL THE WATER IN THE PIT REACHES THE CREST OF THE EMERGENCY OVERFLOW. THE PUMP MUST BE SHUT OFF AT THIS POINT.
8. REMOVE SEDIMENT FROM FILTER BAG, REGRADE IN PLACE, AND IMMEDIATELY STABILIZE.

P:\AutoCAD Libraries\Standard Plates\DWGs\SP69.09.dwg.dwg

	DATE: 3/28/15	<h2 style="margin: 0;">SEDIMENT BAG DEWATERING</h2>	CITY ENGINEER ALLEN GRASSER	DRAWN BY: MPY
			SCALE: NTS	STD. PLATE 69.09

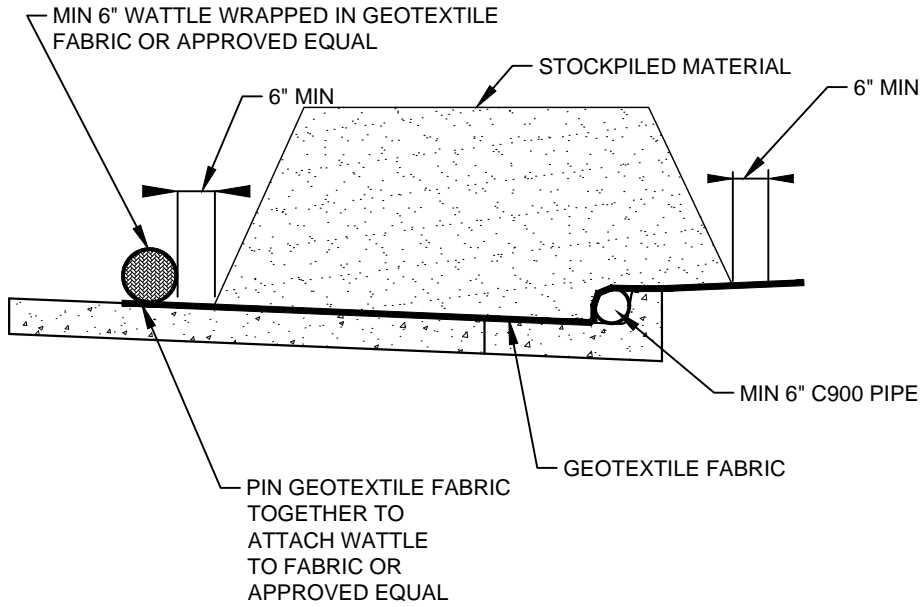
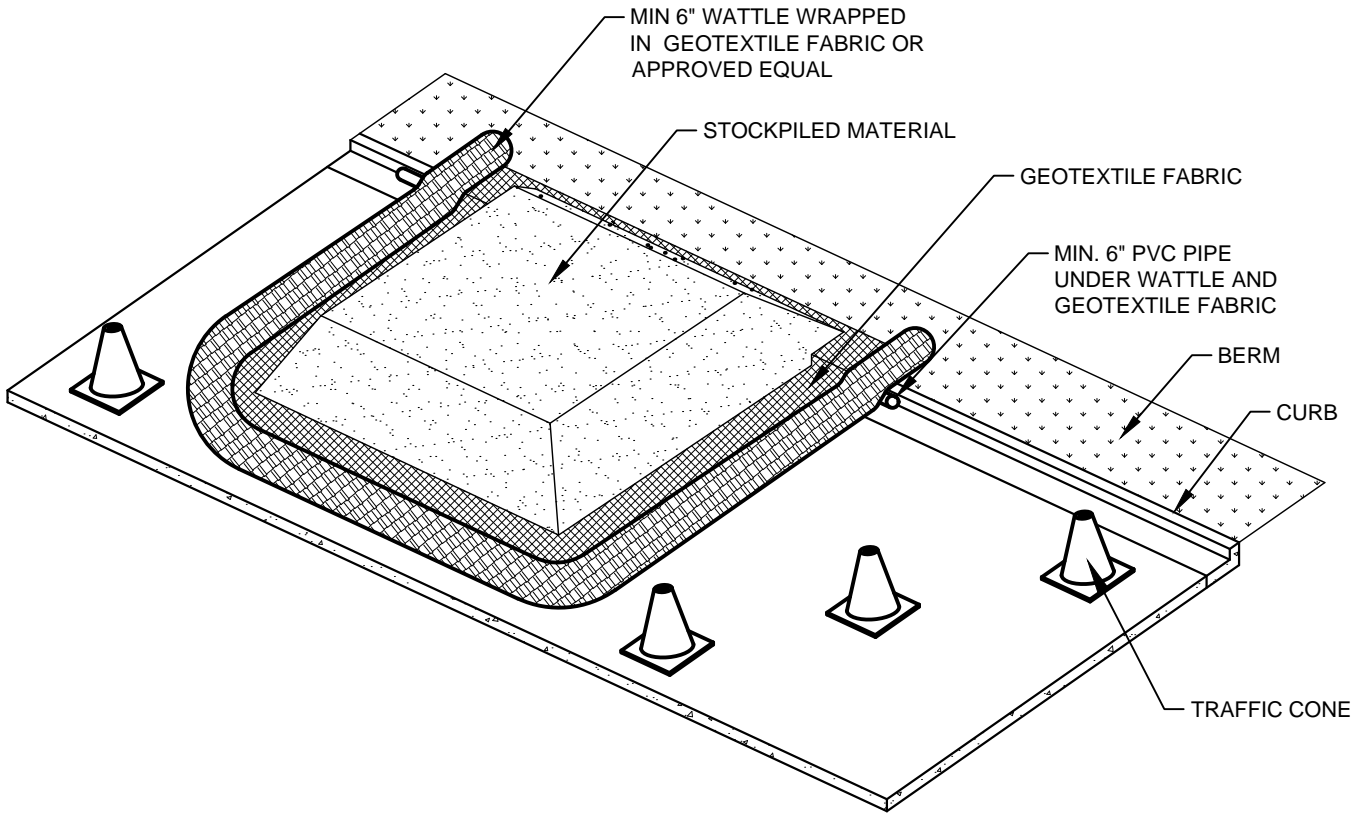

P:\AutoCAD Libraries\Standard Plates\DWGs\SP69.10.dwg.dwg



DATE:  
3/28/15

# STOCKPILE ON STREET

CITY ENGINEER  
ALLEN GRASSER

SCALE:  
NTS

DRAWN BY:  
MPY

STD. PLATE  
69.10

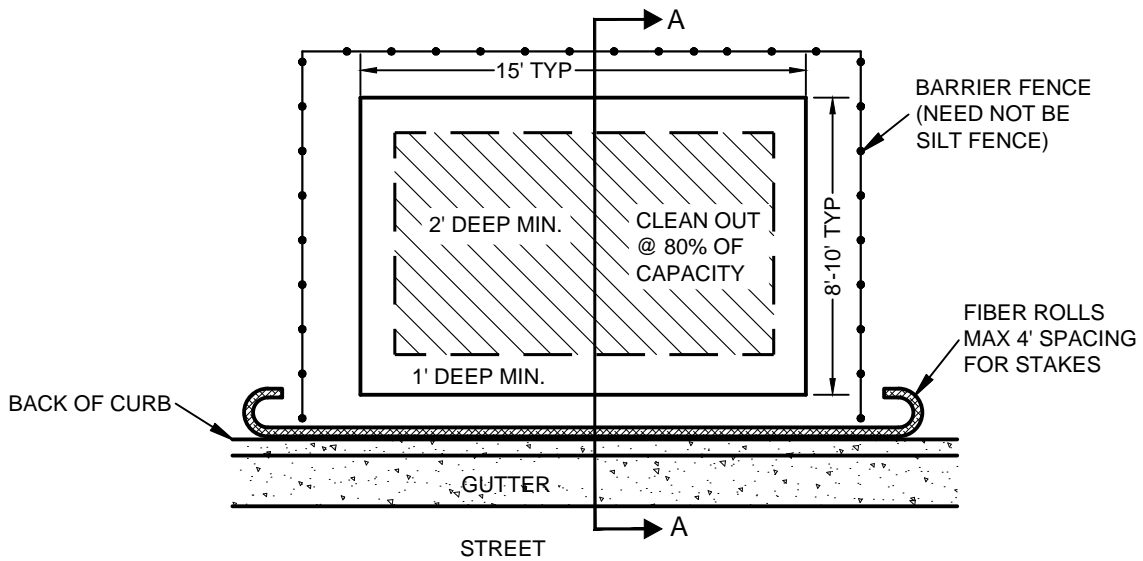

**BELOW GRADE  
PLAN VIEW**

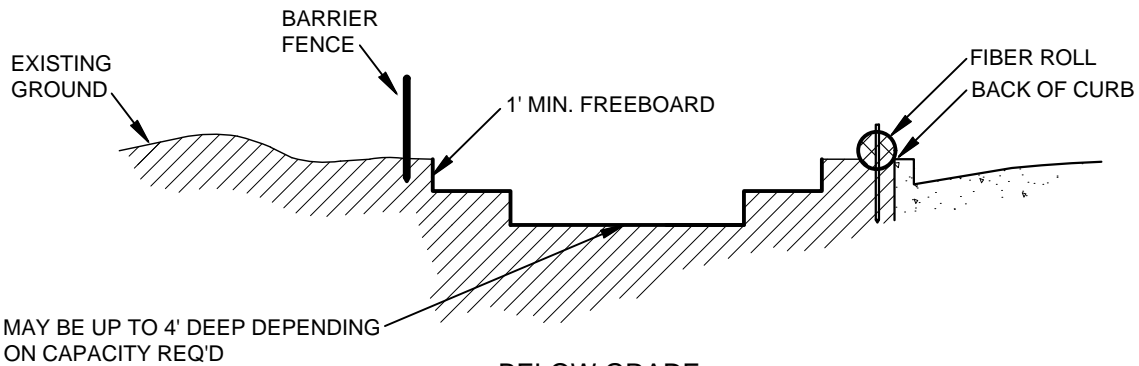

**BELOW GRADE  
SECTION A-A**

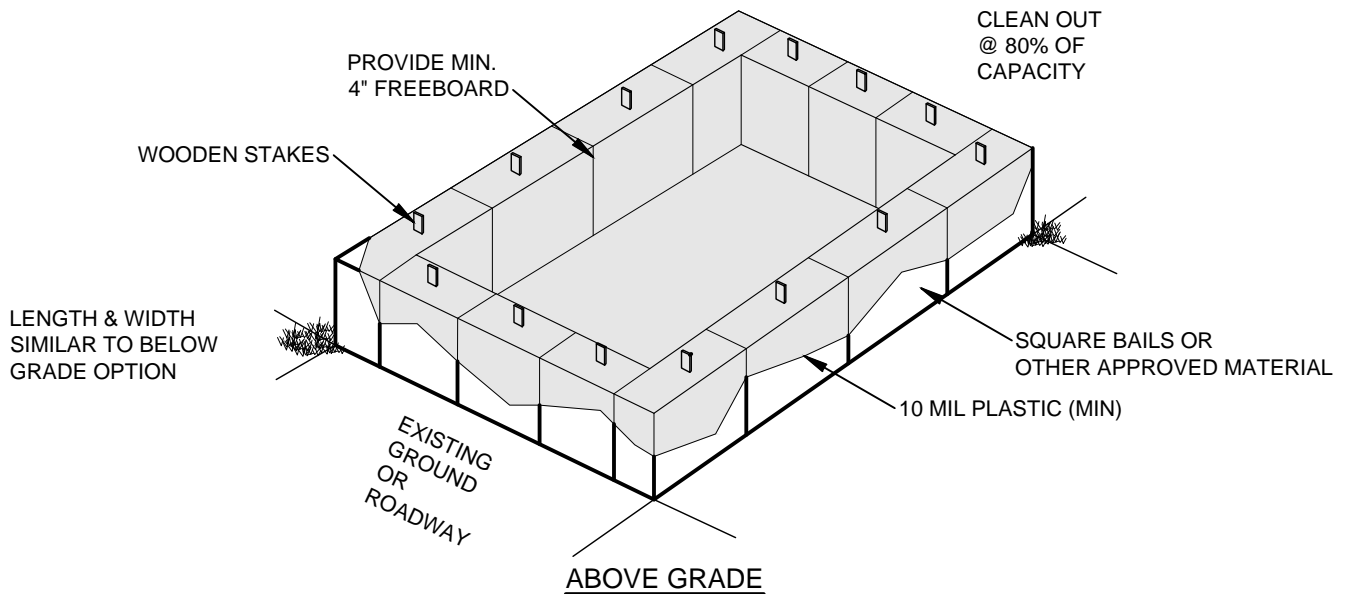

**ABOVE GRADE**

P:\AutoCAD Libraries\Standard Plates\DWGs\SP69.11.dwg.dwg

	DATE: 3/28/15	<h1>CONCRETE WASHOUT</h1>	CITY ENGINEER ALLEN GRASSER	DRAWN BY: MPY
			SCALE: NTS	STD. PLATE 69.11

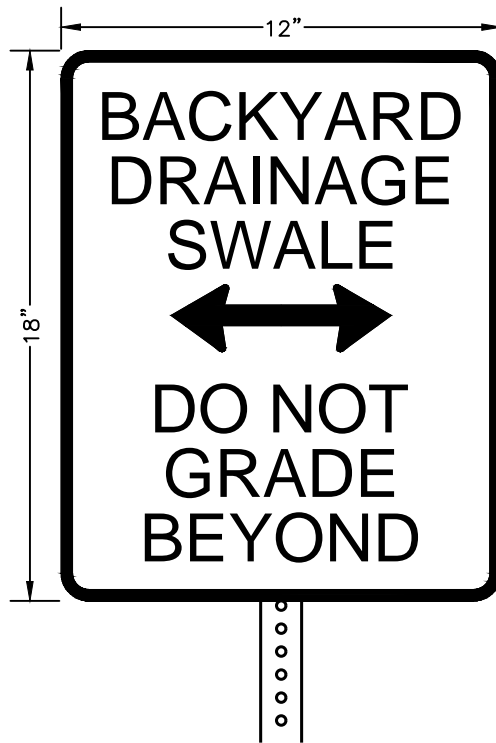

COLORS:  
 LEGEND - WHITE  
 BACKGROUND - GREEN

SIGN DETAILS

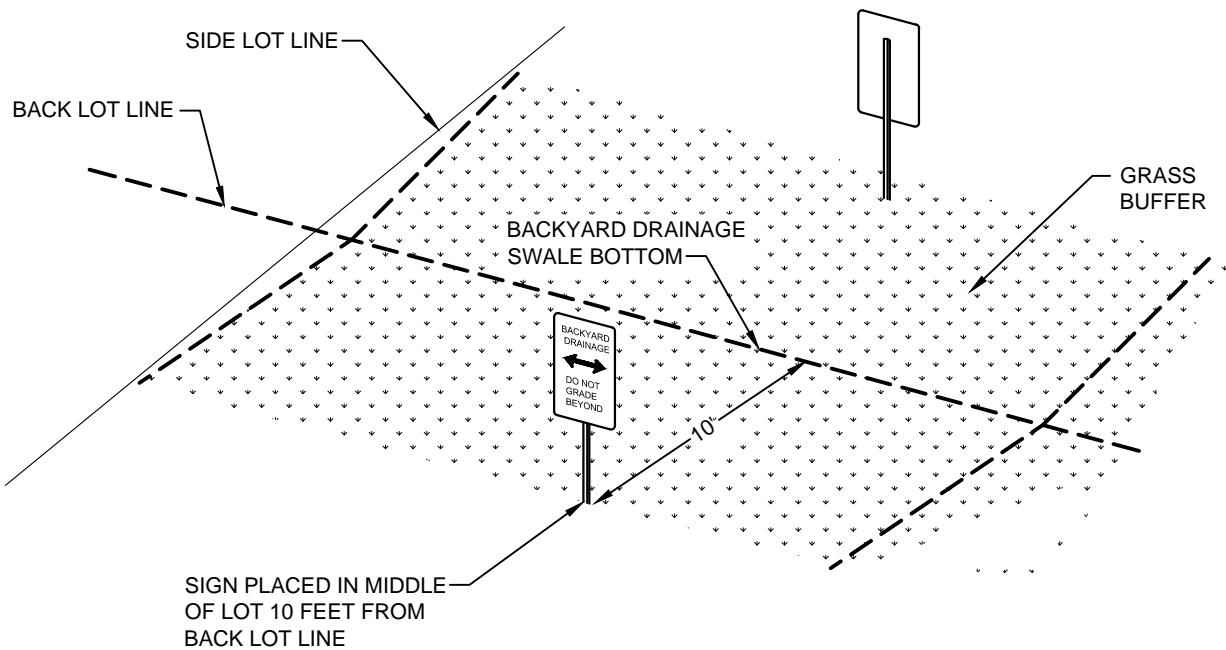

LOCATION DETAILS

P:\AutoCAD Libraries\Standard Plates\DWGs\SP69.12.dwg.dwg

 <p>ENGINEERING DEPARTMENT</p>	DATE: 3/28/15	<h1>BACKYARD DRAINAGE SIGNING</h1>	CITY ENGINEER ALLEN GRASSER	DRAWN BY: MPY
			SCALE: NTS	STD. PLATE 69.12

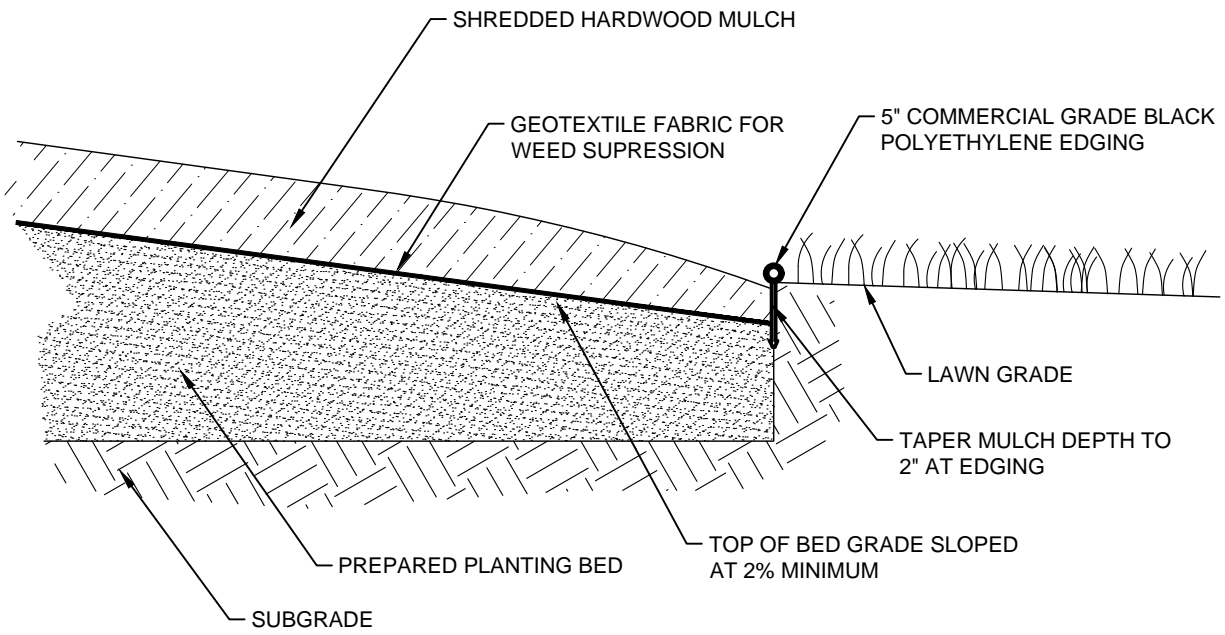

**NOTE:**  
 EDGING IS TO BE STAKED AT A  
 MINIMUM OF EVERY 7 FEET AND AT  
 THE BEGINNING AND END OF EACH  
 LENGTH

P:\AutoCAD Libraries\Standard Plates\DWGs\SP69.13.dwg.dwg

	DATE: 3/28/15	<h1>PLANTING BEDS</h1>	CITY ENGINEER ALLEN GRASSER	DRAWN BY: MPY
			SCALE: NTS	STD. PLATE 69.13