

sanitary sewer but was encountered in the field to be in direct conflict with the sanitary sewer installation and thus had to be relocated. The City watermain was originally designed to be installed in advance of Steffes installing their private water services; however, because the installation of the City watermain was delayed, the services were installed by the time the main was installed so our contractor was required to connect the services. Regarding the number of bid items that were needed to construct the project, quantities of several bid items were underestimated and a larger quantity of work was needed to complete the project.

Regarding the proposed additional City funding of \$205,000, the project as originally proposed included a City share of \$672,000 to account for above normal project costs because of somewhat unique circumstances. A portion of this project involved installing a very deep (up to 28' deep) sewer main in an area with very wet and very soft soil conditions. The proposed sewer main paralleled a water residual forcemain and a large sanitary sewage forcemain previously installed by the City; therefore, it was important that the excavations not negatively impact these forcemains. Several businesses exist adjacent to the new sewer main; therefore, access to the businesses had to be maintained. In addition, there were numerous private utilities in the area which required additional care to work around. Due to depth of the sewer main, poor soil conditions, existing forcemains, access to existing businesses, and existing utilities, the trunk main was installed by first boring in a steel casing pipe and then installing the sanitary sewer main inside of it as opposed to direct burying the sewer main. The additional cost of installing the sewer by first boring in a steel casing pipe above the cost of a typical installation was estimated at \$672,000 which is the reason for the original City share amount. Along this line of thought, staff is suggesting that the additional costs of relocating the rural water main and for the changes necessary for the Highway No. 2 sanitary sewer crossing should be considered a City cost as well. The approximate cost of this additional work, including engineering costs, is \$205,000.

This project has been considered at a number of previous Council/Committee/Public meetings, some of which are as follows:

- June 20, 2016 – Council approved a Utility Permit with the North Dakota Department of Transportation to allow crossing US Highway No. 2 with a Sanitary Sewer main and a Watermain.
- September 6, 2016 – Council approved an Engineering Agreement with AE2S in the amount of \$84,000.
- July 17, 2017 – Council approved the Engineer's Report, created the Special Assessment District, directed Engineering Department to prepare Plans & Specifications and advertise for Construction Bids for this project.
- August 7, 2017 – Council approved Plans & Specifications for this project.
- September 5, 2017 – Council awarded a contract to Sellin Brothers, Inc. in the amount of \$1,880,870.
- July 15, 2019 – Council Approved Amendment No. 1 with AE2S for Additional Engineering Services in the amount of \$93,000.

ANALYSIS AND FINDINGS OF FACT:

- The original bid amount for this project was \$1,880,870.
- Previously approved Change Orders No. 1 and 2 totaled \$105,348.50 which equals 5.6% of the original bid amount.
- Attached Change Order No. 3 is in the amount of \$99,061.90 which will bring the total Change Order amount to 10.9% of the original bid amount.

- Since Change Order No. 3 exceeds the City Engineer's approval authority, approval of Change Order No. 3 will require City Council action.
- Funding for this project will come from special assessment of benefiting properties and a City Share.
- Funding for the original City share of \$672,000 was from the Economic Development Fund 2163 (60% \$403,000) and from the Wastewater Fund 5200 (40% \$ 269,000).
- Funding for the proposed additional City share of \$205,000 is proposed to also be from the Economic Development Fund 2163 (60% \$123,000) and from the Wastewater Fund 5200 (40% \$ 82,000).

SUPPORT MATERIALS:

- Change Order No. 3 (2 pages)
- Project Location Maps (Assessment District Maps – 2 pages)

Change Order

No. 3

Date of Issuance: September 18, 2019 Effective Date: September 18, 2019

Project: N 62 nd St. Sanitary	Owner: City of Grand Forks, ND	Owner's Contract No.: N/A
Contract: CP 7436 & 7437	Date of Contract: October 2, 2017	
Contractor: Sellin Brothers, Inc.	Engineer's Project No.: P00105-2016-017	

The Contract Documents are modified as follows upon execution of this Change Order:

See attached. Quantity Balance and Additional Scope summary (1 page), Cost Breakdown from Sellin Brothers, Inc. (23 pages)

CHANGE IN CONTRACT PRICE:	CHANGE IN CONTRACT TIMES:
Original Contract Price: \$ <u>1,880,870.00</u>	Original Contract Times: <input type="checkbox"/> Working days × Calendar days Substantial completion (days or date): _____ Ready for final payment (days or date): <u>July 13, 2018</u>
[Increase] [Decrease] from previously approved Change Orders No. <u>1</u> to No. <u>2</u> : \$ <u>105,348.50</u>	[Increase] [Decrease] from previously approved Change Orders No. <u>N/A</u> to No. <u>N/A</u> : Substantial completion (days): <u>N/A</u> Ready for final payment (days): <u>N/A</u>
Contract Price prior to this Change Order: \$ <u>1,986,218.50</u>	Contract Times prior to this Change Order: Substantial completion (days or date): _____ Ready for final payment (days or date): <u>July 13, 2018</u>
[Increase] [Decrease] of this Change Order: \$ <u>99,061.90</u>	[Increase] [Decrease] of this Change Order: Substantial completion (days or date): <u>December 14, 2018</u> Ready for final payment (days or date): <u>June 14, 2019</u>
Contract Price incorporating this Change Order: \$ <u>2,085,280.40</u>	Contract Times with all approved Change Orders: Substantial completion (days or date): <u>December 14, 2018</u> Ready for final payment (days or date): <u>June 14, 2019</u>

RECOMMENDED:	ACCEPTED:	ACCEPTED:
By: _____ Engineer (Authorized Signature)	By: _____ Owner (Authorized Signature)	By: _____ Contractor (Authorized Signature)
Date: _____	Date: _____	Date: _____
Approved by Funding Agency (if applicable): _____	Date: _____	

Revision of project scope and plan quantities, summarized as follows:

Revised Quantities:

20" Steel Casing Pipe (Sanitary) increase 80 l.f. @ \$435.00/l.f. =	\$34,800.00
20" Steel Casing Pipe (Water) increase 18 l.f. @ \$395.00/l.f. =	\$7,110.00
Bore & Push 6" PVC C-900 increase 23 l.f. @ \$155.00/l.f. =	\$3,565.00
12" PVC C-900 increase 99 l.f. @ \$97.00/l.f. =	\$9,603.00
Exterior Drop Manhole increase 4.55 l.f. @ \$720.00/l.f. =	\$3,276.00
8" Gate Valve & Box increase 1 ea. @ \$1,950.00/ea.=	\$1,950.00
12" PVC SDR-35 decrease 85 l.f. @ \$82.00/l.f. =	(\$6,970.00)
14" PVC C-900 decrease 212 l.f. @ \$58.00/l.f. =	(\$12,296.00)
Restock Steel Casing reduce 98 l.f. @ \$15.00/l.f. =	(\$1,470.00)

Quantity Adjustment Sub-Total: \$39,568.00

Additional Scope of Work:

Additional crushed concrete along 62 nd and Manhole Adjustment:	\$9,945.55
Repair Leaking Gate Valve by New Vision (leaking prior to tie-in):	\$2,255.00
Steffes Fire Suppression Loop Tie-In:	\$1,947.60
Rural Water Repair and Relocation (Materials):	\$7,974.50
Rural Water Repair and Relocation (Equipment and Labor):	\$37,371.25

Additional Scope of Work Sub-Total: \$59,493.90

Change Order #3 Total \$99,061.90

The Change Order #3 balancing quantities indicated above were the result of decisions made in the field throughout the project duration with verbal agreement from the Owner. The Contractor and Engineer agree with the quantities listed above and no additional quantity adjustment will be made for the remainder of the project.

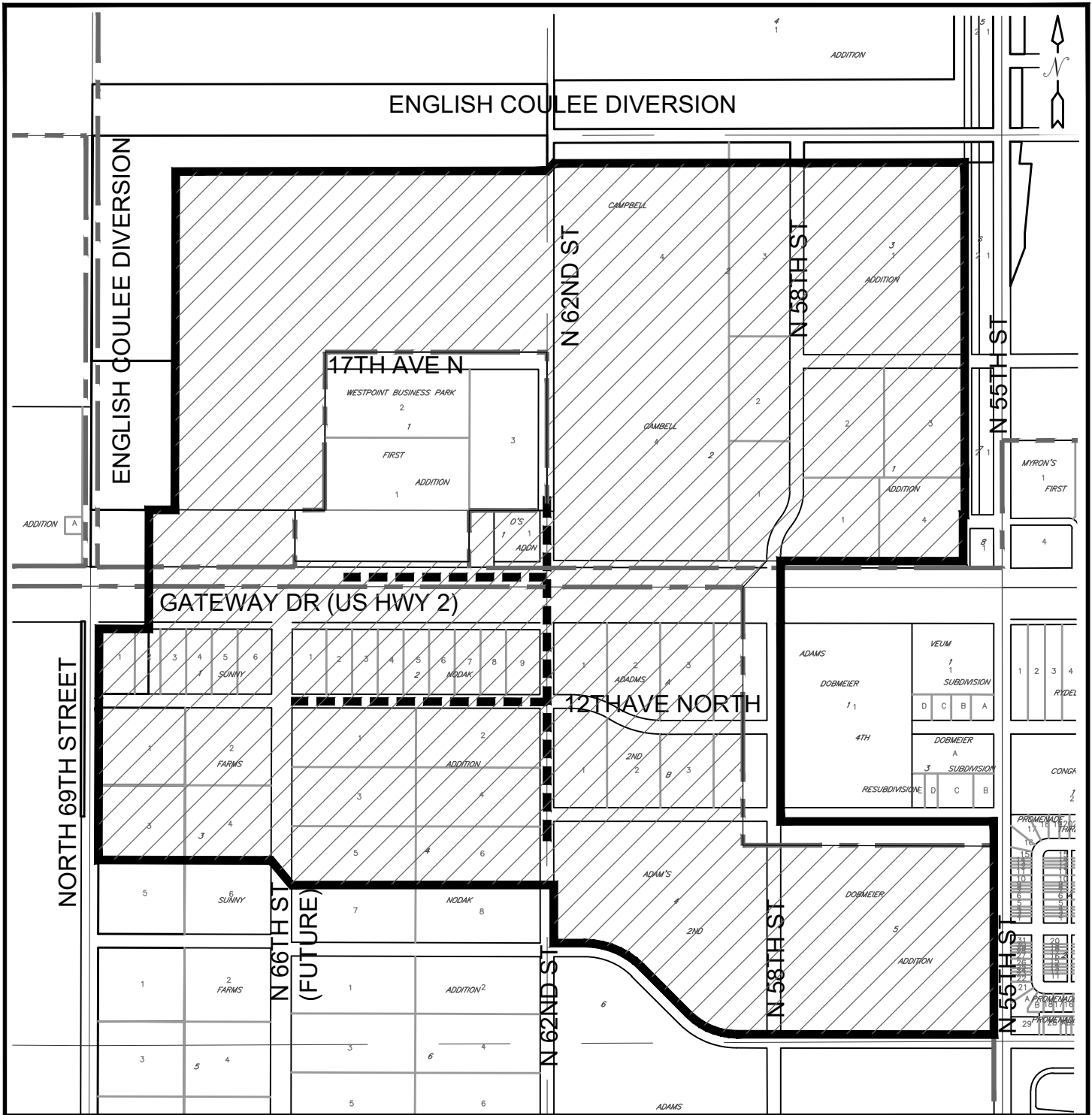

SANITARY SEWER FOR 62ND STREET NORTH AND GATEWAY DRIVE

PROJECT # 7436
DISTRICT # 518

CITY LIMITS
PROJECT LIMITS
ASSESSMENT DISTRICT BOUNDARY
FUTURE ASSESSMENT AREA

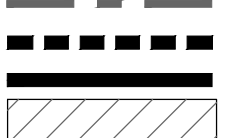

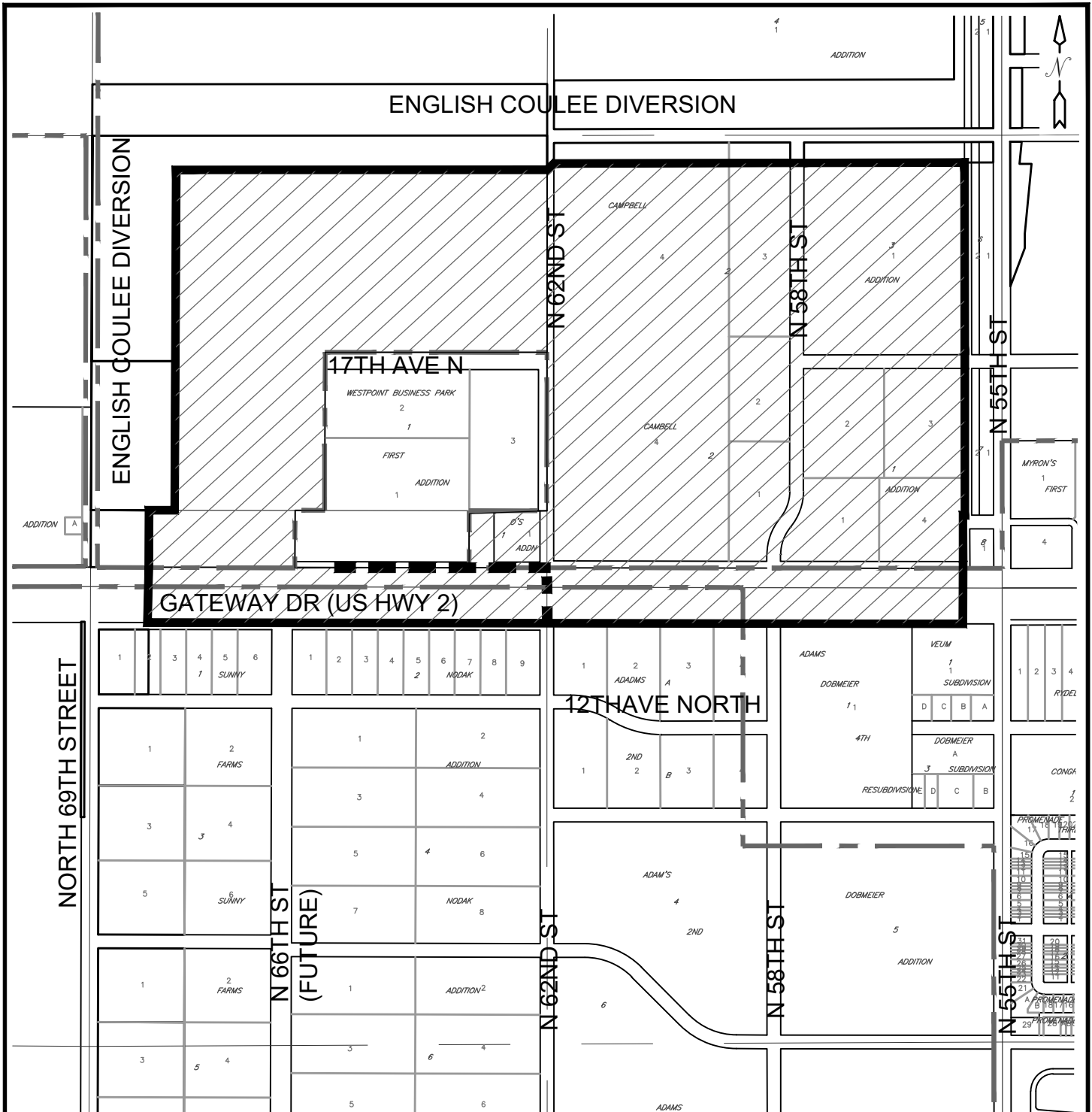

WATERMAIN FOR NORTH 62ND STREET AND GATEWAY DRIVE

PROJECT # 7437
DISTRICT # 323

CITY LIMITS
PROJECT LIMITS
ASSESSMENT DISTRICT BOUNDARY
FUTURE ASSESSMENT AREA

