

WATERMAIN GENERAL NOTES * CITY PROJECT 8931

1. DIMENSIONS SHOWN ARE TO CENTER OF PIPE OR APPURTENANCES AS DRAWN.
2. ALL WATER PIPE SHALL BE INSTALLED WITH A MINIMUM COVER OF 7.5 FT.
3. ALL WM SHALL BE C900 DR-18 PIPE.
4. WATERMAIN AND WM SERVICE TRENCH BACKFILL SHALL BE CLASS 'C' EXCEPT UNDER ALL EXISTING AND PROPOSED PAVEMENT WHERE COMPACTION OF TOP 9" BELOW BASE SHALL BE A MINIMUM OF 100% STANDARD CITY PROCTOR. RE-40504
5. IT SHALL BE THE CONTRACTORS RESPONSIBILITY TO WORK WITH THE CITY TO SCHEDULE AND COORDINATE STREET CLOSURES/DETOURS AND WATERMAIN SHUT DOWNS, TAPS, AND CONNECTIONS.
6. CONTRACTOR SHALL HAVE 10 DAYS FROM THE TIME STREET PAVEMENT, SIDEWALK/BIKEWAYS AND DRIVEWAYS ARE REMOVED TO COMPLETE WATERMAIN TAPS, REPLACE SAID PAVING, AND HAVE IT BACK IN SERVICE. CONCRETE CURE TIME IS INCLUDED IN THE 10 DAY TIME PERIOD.
7. FULL DEPTH SAW CUTTING SHALL BE REQUIRED FOR ALL PAVEMENT REMOVALS.

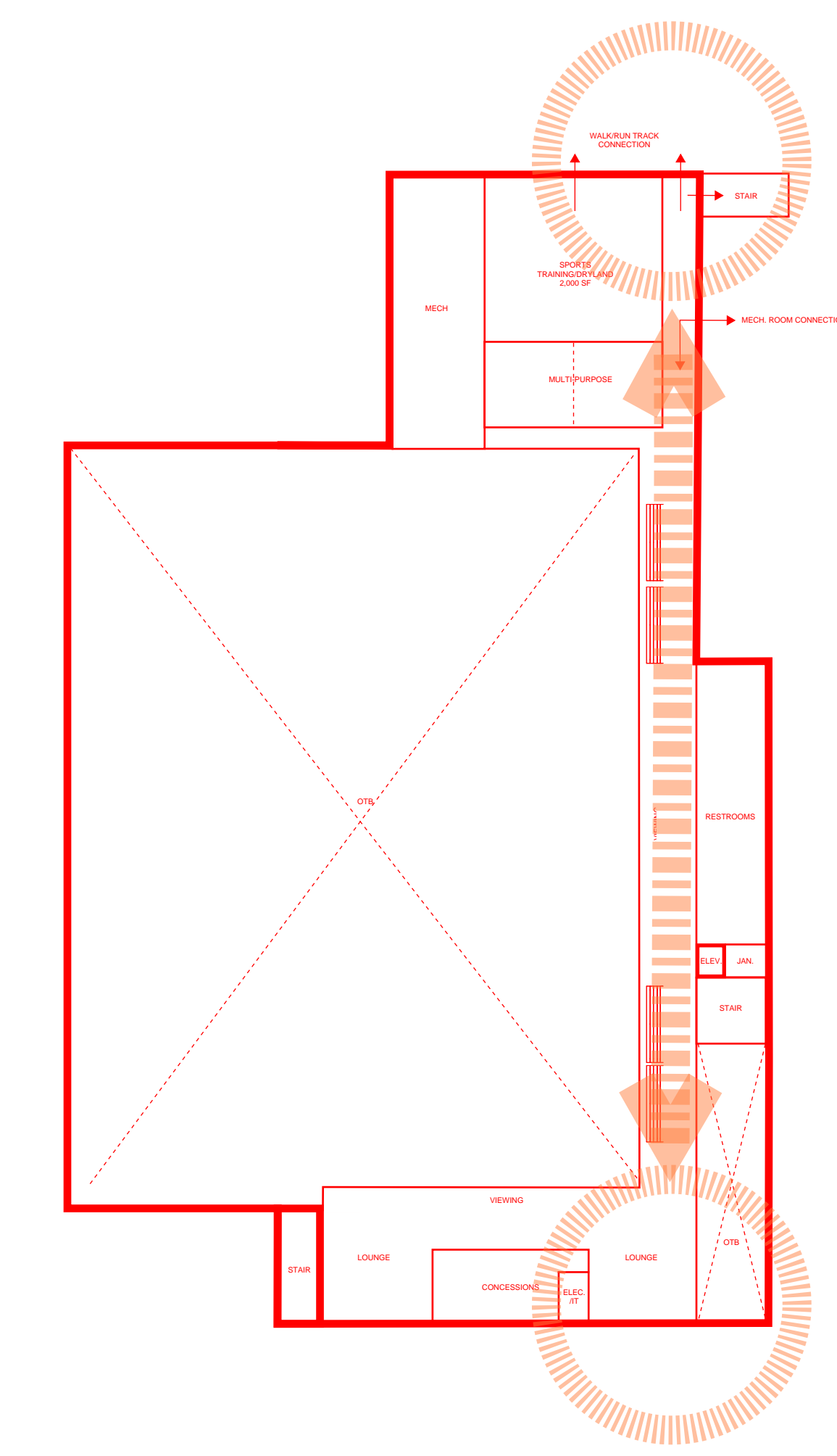
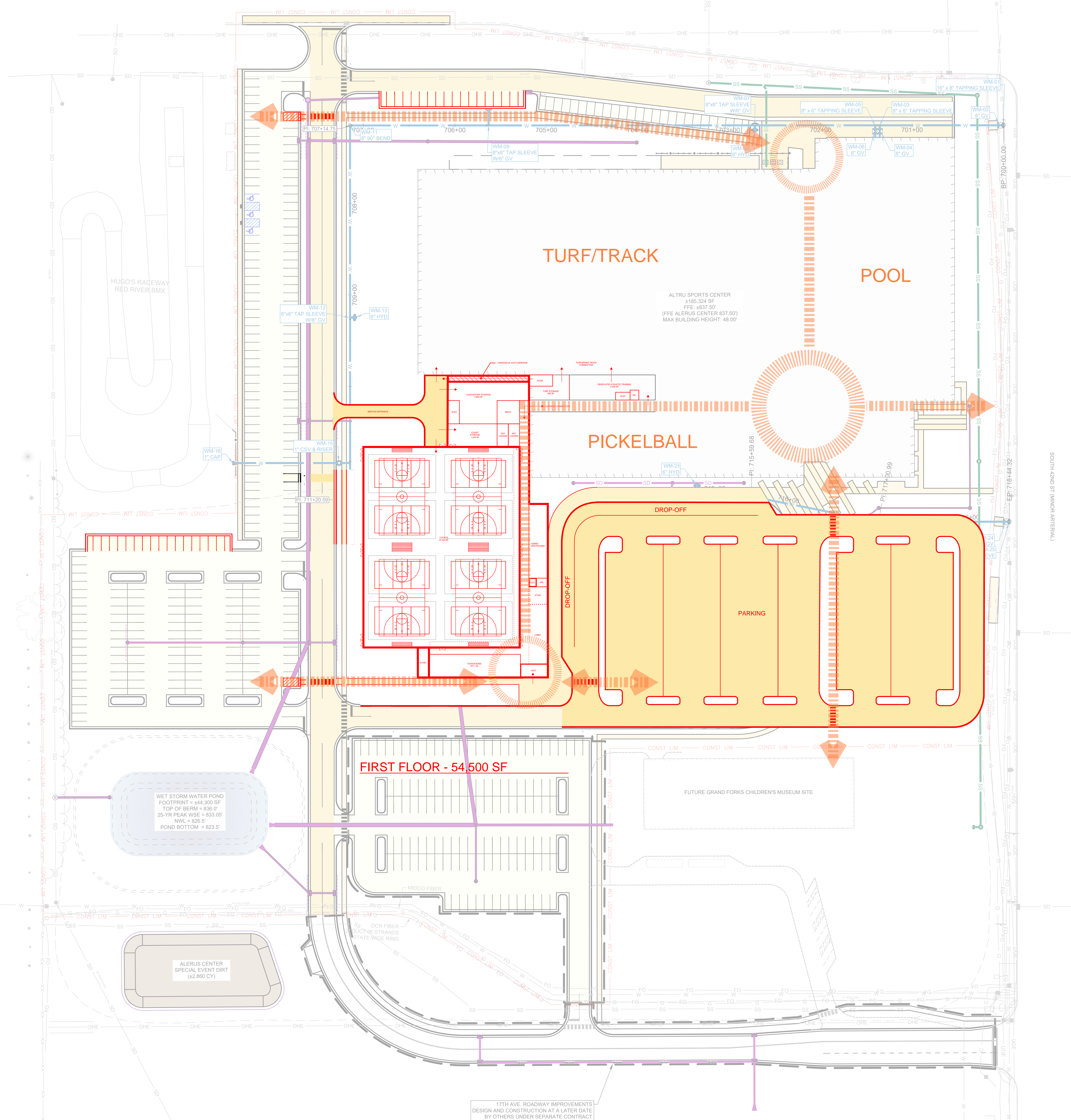

MEZZANINE LEVEL - 16,700 SF

SPACE PROGRAM

- FOUR (4) HS BASKETBALL COURTS
- EIGHT (8) HS VOLLEYBALL COURTS
- EIGHT (8) MS CROSS BASKETBALL COURTS
- EIGHT (8) TEAM ROOMS
- TWO (2) MULTI-PURPOSE ROOMS
 - OPERABLE WALL, EXPANDABLE TO ONE LARGE ROOM
- 4,200 SF SPORTS TRAINING/DRYLAND
 - NEW & RENOVATED
- UPPER LEVEL VIEWING AREAS
- CONCESSION/LOUNGE AREAS
- 1,200 SF OF COURT STORAGE
- NEW FACILITY LOAD-IN AREA
- NEW TURF STORAGE, 3,600 SF

ESTIMATE OF PROBABLE COST

- CONSTRUCTOIN COSTS - 71,200 GSF @ \$300/GSF = \$21,360,000
- SOFT COSTS @ 15% = \$3,204,000.00
- TOTAL PROJECT COSTS = \$24,564,000.00