

**SPECIAL ASSESSMENT COMMISSION MEETING**  
**Minutes**

**Friday, February 21<sup>st</sup>, 2025 – 1:00 p.m. - Griggs Boardroom and Teams**

**Commission Members Present:** Brian Poykko, Emily Fossen  
**Finance Departments:** Stefanie Coleman, Maureen Storstad  
**Engineering Staff:** Rachel Bremer, Shane Duchscher

**1. Approve Minutes**

**a. January 23<sup>rd</sup>, 2025 – Special Assessment Commission Meeting**

*Motion by Fossen, second by Poykko to approve the minutes as submitted.*

*Aye: All. Motion Carried*

**2. Assign Benefit to the following projects:**

**a. Project #8884.1, District #793.1 – Mill & Overlay for Near Northside Neighborhood**

Project location are consists of Near Northside Neighborhood – 4<sup>th</sup> Ave N (N Washington St to mid-block between N 3<sup>rd</sup> St and N 4<sup>th</sup> St), 5<sup>th</sup> Ave N (Railroad to mid-block between N 3<sup>rd</sup> St and N 4<sup>th</sup> St), 6<sup>th</sup> Ave N (Railroad to N 3<sup>rd</sup> St), 7<sup>th</sup> Ave N (Railroad to N 3<sup>rd</sup> St), 8<sup>th</sup> Ave N (Railroad to N 3<sup>rd</sup> St), 9<sup>th</sup> Ave N (N 6<sup>th</sup> St to N 3<sup>rd</sup> St), 10<sup>th</sup> Ave N (N 6<sup>th</sup> St to N 3<sup>rd</sup> St), 11<sup>th</sup> Ave N (175' SW of N 5<sup>th</sup> St to Gateway Dr), N 6<sup>th</sup> St (University Ave to 10<sup>th</sup> Ave N), N 7<sup>th</sup> St (University Ave to 8<sup>th</sup> Ave N), N 8<sup>th</sup> St (University Ave to 6<sup>th</sup> Ave N), N 11<sup>th</sup> St (University Ave to 5<sup>th</sup> Ave N).

Project location are consists of Near Northside Neighborhood – 4<sup>th</sup> Ave N (N Washington St to mid-block between N 3<sup>rd</sup> St and N 4<sup>th</sup> St), 5<sup>th</sup> Ave N (Railroad to mid-block between N 3<sup>rd</sup> St and N 4<sup>th</sup> St), 6<sup>th</sup> Ave N (Railroad to N 3<sup>rd</sup> St), 7<sup>th</sup> Ave N (Railroad to N 3<sup>rd</sup> St), 8<sup>th</sup> Ave N (Railroad to N 3<sup>rd</sup> St), 9<sup>th</sup> Ave N (N 6<sup>th</sup> St to N 3<sup>rd</sup> St), 10<sup>th</sup> Ave N (N 6<sup>th</sup> St to N 3<sup>rd</sup> St), 11<sup>th</sup> Ave N (175' SW of N 5<sup>th</sup> St to Gateway Dr), N 6<sup>th</sup> St (University Ave to 10<sup>th</sup> Ave N), N 7<sup>th</sup> St (University Ave to 8<sup>th</sup> Ave N), N 8<sup>th</sup> St (University Ave to 6<sup>th</sup> Ave aN), N 11<sup>th</sup> St (University Ave to 5<sup>th</sup> Ave N).

To serve the following platted lands to the City of Grand Forks: Lot 2 & NW 21' of Lot 4, SE 4' of Lot 4 & Lot 6, Lots 8, 10, 12, 14, 16, 18, 20, 22, 24, 26, 28, 30, 32, Block 36; Lots 2, 4, 6, 8, 10, 12, 14, 16, 18, 20, 22, 24, 26, 28, 30, 32, Block 44; Lots 19-32 inclusive block 45, Lots 17 & 18, Block 45; Lots 1-6 less front 3' for hwy R/W, Block 48; Lots A-C, Lots 6 & 8, Lots 10 & 12, Lots 14 & 16, Lots 17-32, Block 49; Lot A, Block F; NW 151' of block E, SRLY 101.4' of block E including the NRLY ½ of vac 13<sup>th</sup> Ave N, Block E; Lot A block E & Lot 1 & block 50 vac st, Lot 2 & 3 fractional block, Lots 4-13, SE 21 ½' of Lot 14 and NE 6' of NE 90' of Lot 15 except triang tract out of the NE corner 11' on 5<sup>th</sup> St & 21' deep, Rear 50' of Lots 15 & 16, Front 90' of SE 19' of Lots 15 & front 90' of Lot 16 and also triang tract of NW corner of Lot 15 & NE corner of Lot 14 and 11' on 5<sup>th</sup> St X 21' deep, Lot 17 & all of vac street SE adj thereto, Block 50; Lots 1 & 2, Lots A-C, Lots 9-16, Lots 17-20, Front part of Lots 26-28 & all of 29 plus NW ½ of vac alley adj to said lots which is w/in 125' E & parallel w/the BNRR main track center line, Lot 25 & rear part of Lots 26-28 & NW ½ of alley vac & lying contiguous to Lots 25-28 except portion to GN, Lots 21-23 & Lot 24 plus the SW ½ of vac alley adj to

“

said Lot 24 which is w/in 125' E & parallel w/the BNRR amin track ctr line, Rear part of Lots 21-23 & Lot 24 & SE ½ of the alley vac & lying contiguous to Lot 24 except portion to Great Northern RR, Block 51; All of block D less that part that is located 25' E of the most E spur track C/L, Adj all that pt of Block D located 25' E of most E spur track C/L, Block D; Lots 1-22, Lots 23 & N 10' of Lot 25, S 15' of Lot 25 & all of Lot 27, Lots 24, 26, 28-32, Block 52; Lots 1-28, Front 80' of Lots 29 & 31, Rear 60' of Lots 29 & 31, Front 70' of Lots 30 & 32, Rear 70' of Lots 30 & 32, Rear 65' of SE 5' & rear 11' of NW 2' of SE 7' of Lot 28 & rear 65' of Lots 30 & 32, Block 53; Lots 1-32, Block 54; Lots 1-12, Lot 13 & 15, Lot 14 & NW ½ of Lot 16, Lot 17, SE ½ of Lot 16 & all of Lots 18 & 20, Lots 21-24, Lots 25 & 27, All of Lot 26 & that portion of Lot 28 except SE 5' and less rear 11' of NW 2' of SE 7', Front 75' of SE 5' of Lot 28 & Front 75' of Lots 30 & 32, Front 90' of Lots 29 & 31, Rear 50' of Lots 29 & 31, Block 55; Front part of Lots 7-16 inclusive except rear part to GNRR, Adj Lots 1-6 inclusive & rear pt of Lots 1-16 inclusive that is 125' E of C/L of main track less that pt 25' E of most E spur track C/L, Block 56; Lots 1-2, Lots 3 & N 15' of Lot 4, S 10' of Lot 4 & all of Lots 5 & 6, Lots 7-10, Lot 11 & N ½ of Lot 12, S ½ of Lot 12 & all of Lot 13, Front 80' of Lots 14-16, Rear 50' of Lots 14-16, Lots 17 & 18, Lots 19-22 front pt less right-of-way, (Adj) Rear pt of Lots 19-22 located 125' E & parallel to main track C/L less that pt 25' E of the most E spur track C/L, Lots 24 & 25 rear part less right-of-way, Lot 26 rear part less right-of-way, Lots 23-26 located 125' E & parallel to main track C/L less pt 25' E of most E spur track C/L, All that pt of Lot 22 located 25' E of the most E spur track C/L, All that pt of Lots 23 & 24 located 25' E of the most E spur track C/L, Block 57; Lots 1-4 less that pt located 25' E of the most E spur track C/L, Lots 5-16 located 125' E of & parallel to C/L of main track C/L less pt 25' E of most E spur track C/L, Front pt of Lots 5-8, Adj front part of lot 9, Front part of Lots 10-16, Lots 1-16 Located 125' E of the most E spur track C/L, Block 58, Alexander & Ives' Addition; SW 88' of Lots 2 & 4 & SW 88' of NW 1' of Lot 6, Lots 2 & 4 except SW 88' & NW 1' of Lot 6 except SW 88' of Lot 2, SE 24' of Lot 6, Lot 8 & N ½ of Lot 10, S ½ of Lot 10 & all of Lot 12, Lots 14, 16, & 18, Lots 15, 17, 19, Front 80' of Lots 21 & 23, Rear 60' of Lots 21 & 23, Front 61' of Lots 20, 22, & 24, Front 42 1/2' of rear 79' of Lots 20, 22, & 24, Rear 36 ½' of Lots 20, 22, & 24, Block 23; Lot 18, Lot 20, Front or SW 70' of Lots 22 & 24, Lots 22 & 24 less the front or SW 70', Block 27, Budge & Eshelman's 2<sup>nd</sup> Addition; Lots 1 & 3, Lot 2 & N ½ of Lot 4, S ½ of Lot 4 & all of Lot 6, Lot 5 & N 12 182' of Lot 7, S 12 ½' of Lot 7 & all of Lot 9, Lot 8, Lots 10-14, Block 24; Lots 2, 4, & 6, Block 4; Lots 1-12, Lots 13 & N ½ of Lot 15, Lots 14 & 16, S ½ of Lot 15 & all of Lot 17, Lots 18-29, NE 70' of Lot 30 & all of Lot 32, Lot 30 less the NE 70', Lot 31, Block 27; Front 92.5' of Lots 1 & 3, Rear 47.5' of Lots 1 & 3, Lot 2, Lots 4-32, Block 28; Lots 1-3, Lots 4 & 6, Lot 5 & 7 & NW 2' of Lot 9, Lots 8 & 10, SE 23' of Lot 9 & all of Lot 11, Lots 12-17, Lot 18 & NW 2' of Lot 20, SW 23' of Lot 20, Lot 19 & N 10' of Lot 21, S 15' of Lot 21 & all of Lot 23, Lots 22 & 24, Lots 25 & N 9' of Lot 27, Lot 26 & W ½ of Lot 28, S 16' of Lot 27 & N 17' of Lot 29, E ½ of Lot 28 & all of Lots 30 & 32, SE 8' of Lot 29 & all of Lot 31, Block 29; Front 100' of Lots 1 & 3, Rear 40' of Lots 1 & 3, Lots 2 & 4, Lots 5-17, Lots 18-22, & 24, Lot 23 & N ½ of Lot 25, S ½ of Lot 25 & all of Lot 27, Lot 26, Lots 28-31, SW 95' of Lot 32, NE 45' of Lot 32, Block 30; Front 46' of Lots 1, 3, 5, & 7, Rear 39' of front 85' of Lots 1, 3, 5, & 7, SE 15' of rear 55' of Lot 5 & rear 55' of Lot 7, Rear 55' of Lots 1 & 3 & rear 55' of NW 10' of Lot 5, Lots 2, 4, 6, 8-12, Lot 13 7 N ½ of Lot 15, Lots 14 & 16, S ½ of Lot 15 & all of Lot 17 & N ½ of Lot 19, Lot 18, S ½ of Lot 19 & all of Lots 21 & 23, Lots 20, 22, 24-28, Front 76' of Lots 29 & 31, Rear 64' of Lots 29 & 31, Front 90' of Lots 30 & 32, Rear 50' of Lots 30 & 32, Block 31; Lots 1-8, Lots 9 & 11, Lot 10, 12, and N ½ Lot 14, Lots 13 & 15, S ½ of Lot 14 & N ½ of Lot 16, S ½ of Lot 16 & all of Lots 18 & 20, Lot 17 & N 10' of Lot 19, S 15' of Lot 19 & all of Lot 21, Lot 22 & N 15' of Lot 24, S 10' of Lot 24 & all of Lot 26 & N 15' of Lot 28, Lots 23 & 25 & NW 20' of Lot 27, SE 5' of Lots 27 & all of Lots 29 & 31, S 10' of Lot 28 & all of Lots 30 & 32,

Block 35; Lots A & B, S 5' of Lot 5 & all of Lot 7, Lots 9, 11, 13, 15, 17, 19, 21, & 23, Front 90' of Lot 25 & N 5' of front 90' of Lot 27, S 20' of front 90' of Lot 27 & N 15' of front 90' of Lot 29, S 10' of front 90' of Lot 29 & front 90' of Lot 31, Rear 50' of Lots 25, 27, 29, & 31, Block 36; Front 70' of Lot 1 & 3, Rear 70' of Lots 1 & 3, Front 89 ½' of Lots 2 & 4, Rear 50 ½' of Lots 2 & 4, Lots 5-15, Lot 16 & N ½ of Lot 18, S ½ of Lot 18 & all of Lot 20, Lots 17 & 19, Lots 21-32, Block 37; Lots 1-4, Lot 5 & N 8 1/3' of Lot 7, Lots 6 & 8, S 16 2/3' of Lot 7 & N 16 2/3' of Lot 9, S 8 1/3' of Lot 9 & all of Lot 11, Lots 10 & 12, Lots 13-32, Block 38; Lots 1-3, Lot 2, Lot 4 & N 10' of Lot 6, S 15' of Lot 6 & all of Lot 8, Lots 5 & 7, Lots 9-14, Lots 15, 17, 19, & 21, Lots 16 & 18 & NW ½ of Lot 20, SW ½ of Lot 20 and all of Lots 22 and 24, Lots 23 & 25, Lots 26, 28, 30 and 32, Lot 27 & N ½ of Lot 29, S ½ of Lot 29 & all of Lot 31, Block 43; Lot 1, Lot 3 & N ½ of Lot 5, S ½ of Lot 5 & all of Lot 7, Lots 9, 11, 13, 15, 17, 19, 21, 23, 25, 29, 31, Block 44, McCormack's 1<sup>st</sup> Addition; Lots 1-4, Lot 5 & N 12 ½' of Lot 6, S 12 ½' of Lot 6 & all of Lot 7, Lot 8 & N ½ of Lot 9, A ½ of Lot 9 & all of Lot 10, Lot 11, Block 45; All of said block-except the 5' X 10' strip of land bordering the SE row of 11<sup>th</sup> Ave S McCormack's 1<sup>st</sup> & 2<sup>nd</sup> Addn, Block 46, McCormack's 2<sup>nd</sup> Addition; Lots A, B, Front 60' of Lot 2, Rear 38' of front 98' of Lot 2, Rear of NE 42' of Lot 2, N ½ of Lot 4, S ½ of Lot 4 & strip of land off the NW side of Lot 6 having a width of 14" at alley & tapering to 0 width at inside sidewalk line on 4<sup>th</sup> St, Lot 5, Lot 6, Less a strip of land off the NW side having a width of 14" at alley & tapering to 0 width at the inside sidewalk line on 4<sup>th</sup> St, Block 2; Front 105' of Lot 1, Rear 35' of Lot 1, Lot 2, N ½ of Lot 3, S ½ of Lot 3, Lots 4 & 5, N ½ of Lot 6, S ½ of Lot 6, Block 3, Original Townsite Grand Forks; Lots 1, 3, 5, 7, 9, 11, 13, - part of B & E 2<sup>nd</sup> & McCormack's 1<sup>st</sup> Addn; Block 23; Lots 1, 3, 5, 8, 10 & 12 - part of O.T. & McCormack's 1<sup>st</sup> Addn, Lots 12-16 - part of block 45 McCormack's 1<sup>st</sup> & 2<sup>nd</sup> Addn, Block 45; All of said block - part of block 46 McCormack's 1<sup>st</sup> & 2<sup>nd</sup> Addn, Block 46, Partly Lots; A 30'X90' tract lying 140' SE, of the N sec line & parallel, Unplatted Parts-Grand Forks TWP.

The benefits received from the project are for access, both for property and fire protection, dust suppression, pedestrian accommodations and providing some drainage control. Based on these factors, we anticipate that the benefits will exceed the cost of the project.

The map of the project was presented by the Finance and Engineering Departments.

**Motion by Fossen, second Poykko, to assign benefit, pending a positive cost benefit analysis is presented by city staff at the time of bid, as follows: (Benefit maps attached)**

**8<sup>th</sup> Ave N-**

- **The Commissioner assigned benefit to the district based on square footage, with 1.0 for full frontage, and ¼ for sideage.**
- **Rear 60' of Lots 29 & 31, Front 70' of Lots 30 & 32, Rear 70' of Lots 30 & 32, Block 53, Front 80' of Lots 14-16, Rear 50' of Lots 14-16, Block 57, Alexander & Ives Addition, received full benefit the entire area of the lot.**
- **Lots 17 & 18, (Adj) Rear pt of Lots 19-22 located 125' E & parallel to main track C/L less that pt 25' E of the most E spur track C/L, Lots 19-22 front pt less right-of-way, Block 57, Alexander & Ives Addition, received full benefit for 140' back from the project on 8<sup>th</sup> Ave N and ¼ benefit for the remaining area of the lot;**
- **Lot 2 & NW 21' of Lot 4, SE 4' of Lot 4 & Lot 6, Lots 8, 10, 12, 14, 16, 18, 20, 22, 24, 26, 28, 30, 32, Block 36, Alexander & Ives Addition; Front 89 ½' of Lots 2 & 4, Rear 50 ½' of**

Lots 2 & 4, 6, 8, 10, 12, 14, 16 & North ½ fo lot 18, South ½ of Lot 1/ & all of Lot 20, 22, 24, 26, 28, 30, 32, Block 37, Alexander & Ives Addition; Lots 2, 4, 6, 8, 10, 12, 14, 16, 18, 20, 22, 24, 26, 28, 30, 32, Block 44, Alexander & Ives Addition; Lots 19-32 inclusive block 45, Lots 17 & 18, Block 45, Alexander & Ives Addition; Lots 1-6 less front 3' for hwy R/W, Block 48, Alexander & Ives Addition; Lots A-C, Lots 6 & 8, Lots 10 & 12, Lots 14 & 16, Lots 17-32, Block 49, Alexander & Ives Addition; Lot A, Block F, Alexander & Ives Addition; NW 151' of block E, Lot B replat of SRLY 101.4' of block E including the NRLY ½ of vac 13<sup>th</sup> Ave N, Block E, Alexander and Ives' Addition; Lot A block E & Lot 1 & block 50 vac st, Lot 2 & 3 fractional block, Lots 4-13, SE 21 ½' of Lot 14 and NE 6' of NE 90' of Lot 15 except triang tract out of the NE corner 11' on 5<sup>th</sup> St & 21' deep, Rear 50' of Lots 15 & 16, Front 90' of SE 19' of Lots 15 & front 90' of Lot 16 and also triang tract of NW corner of Lot 15 & NE corner of Lot 14 and 11' on 5<sup>th</sup> St X 21' deep, Lot 17 & all of vac street SE adj thereto, Block 50; Lots 1 & 2, Lots A-C, Lots 9-16, Lots 17-20, Front part of Lots 26-28 & all of 29 plus NW ½ of vac alley adj to said lots which is w/in 125' E & parallel w/the BNRR main track center line, Lot 25 & rear part of Lots 26-28 & NW ½ of alley vac & lying contiguous to Lots 25-28 except portion, to GN, Front part of L,ots 21-23 & Lot 24 plus the SW ½ of vac alley adj to said Lot 24 , which is w/in 125' E & parallel w/the BNRR amin track ctr line, Rear part of Lots 21-23 & Lot 24 & SE ½ of the alley vac & lying contiguous to Lot 24 except portion to Great Northern RR, Block 51, Alexander and Ives' Addition; All of block D less that part that is located 25' E of the most E spur track C/L, Adj all that pt of Block D located 25' E of most E spur track C/L, Block D; Lots 1-22, Lots 23 & N 10' of Lot 25, S 15' of Lot 25 & all of Lot 27, Lots 24, 26, 28-32, Block 52, Alexander & Ives Addition; Lots 1-28, Front 80' of Lots 29 & 31,, Block 53 Alexander & Ives Addition; Lots 1-32, Block 54, Alexander & Ives Addition; Lots 1-12, Lot 13 & 15, Lot 14 & NW ½ of Lot 16, Lot 17, SE ½ of Lot 16 & all of Lots 18 & 20, Lot 19, Lots 21-24, Lots 25 & 27, All of Lot 26 & that portion of Lot 28 except SE 5' and less rear 11' of NW 2' of SE 7', Front 75' of SE 5' of Lot 28 & Front 75' of Lots 30 & 32, Front 90' of Lots 29 & 31, Rear 50' of Lots 29 & 31, Block 55, Alexander & Ives Addition; Front prt of Lots 7-16 inclusive except rear part to GNRR, Adj Lots 1-6 inclusive & rear pt of Lots 1-16 inclusive that is 125' E of C/L of main track less that pt 25' E of most E spur track C/L, Block 56, Alexander & Ives Addition; Lots 1-2, Lots 3 & N 15' of Lot 4, S 10' of Lot 4 & all of Lots 5 & 6, Lots 7-10, Lot 11 & N ½ of Lot 12, S ½ of Lot 12 & all of Lot 13, Lots 24 & 25 rear part less right-of-way, Lot 26 rear part less right-of-way, Lots 23-26 located 125' E & parallel to main track C/L less pt 25' E of most E spur track C/L, Block 57, Alexander & Ives Addition; Lots 1-4 less that pt located 25' E of the most E spur track C/L, Rear Part of Lots 5-16 located 125' E of & parallel to C/L of main track C/L less pt 25' E of most E spur track C/L, Front pt of Lots 5-8, Adj front part of lot 9, Front part of Lots 10-16, Block 58, Alexander & Ives' Addition; All of said block – part of Block 46, except the 5'x10' strip of land bordering the southeasterly row of 11<sup>th</sup> Ave S MC Cormac's 1<sup>st</sup> & 2<sup>nd</sup> Addition, McCormack's Second Addition; Lots 2, 4 & 6, Block 4, McCormack's 1<sup>st</sup> Addition; Lots, 1 & 3, Lot 2 North ½ of Lot 4, Lot 5 & North 12 ½' of Lot 7, South ½ of Lot 4 7 All of Lot 6, South 12 ½' of Lot 7 & All of Lot 9, Lots 8, 10, Lots 11 & 13, Lots 12 & 14, Block 24, McCormack's 1<sup>st</sup> Addition; Lots 1 – 12, 14, 16, 18, 20, 22, 24, Lots 13 & North ½ of Lot 15, South ½ of Lot 15 & all of Lot 17, Lots 19 & 21, Lots 23, 25, & 27, 26, 28, Adj Lot 29, 31, the Northeasterly 70' of Lot 30 & all of Lot 32, Block 27, McCormack's 1<sup>st</sup> Addition; Front 92.5' of Lot 1 & 3, Rear 47.5' of Lots 1 & 3, Lot 2, 4 –

32, Block 28, McCormack's 1<sup>st</sup> Addition; Lots 1, 2, 3, 4, 6, Lots 5 & 7 & Northwest 2' of Lot 9, 8 & 10, Southeast 23' of Lot 9 & All of Lot 11, 12, 13 – 17, Lot 18 & Northwest 2' of Lot 20, Lot 19 & North 10' of Lot 21, Southeasterly 23' of Lot 20, South 15' of Lot 21 7 all of Lot 23, 22, 24, Lot 25 & North 9' of Lot 27, Lot 26 & West ½ of Lot 28, South 16' of Lot 27 & North 17' of Lot 29, Southeast 8' of Lot 29 and all of Lot 31, East ½ of Lot 28 and All of Lot 30 & 32, Block 29, McCormack's 1<sup>st</sup> Addition; Front 100' of Lots 1 & 3, Rear 40' of Lots 1 & 3, 2, 4 – 17, 18, 19, 20, 21, 22, 24, Lot 23 & North ½ of Lot 25, 26, South ½ of Lot 25 & all of Lot 27 – 31, Northeast 45' of Lot 32, Southwest 95' of Lot 32, Block 30, McCormack's 1<sup>st</sup> Addition; Rear 55' of Lot 1 & 3 & Rear 55' of NRLY 10' of Lot 5, Rear 39' of Front 85' of Lot 1, 2, 3, & 7 and SE 15' of Rear 55' of Lot 5 & Rear 55' of Lot 7, Front 46' of Lots 1, 3, 5 & 7, Lots 2, 4, 6, 8 – 12, Lot 13 & North ½ of Lot 15, Lots 14 & 16, South ½ of Lot 15 and All of Lot 17 & North ½ of Lot 19, Lots 18 & 20, South ½ of Lot 19 & all of Lot 21 & 23, Lots 22, 24 – 28, Front 76' of Lots 29 & 31, Rear 64' of Lot 29 & 31, Rear 50' of Lots 30 & 32, Front 90' of Lots 30 & 32, Block 31, McCormack's 1<sup>st</sup> Addition; Lots 1 – 11, 12 & N ½ of 14, 13, 15, South ½ of Lot 14 & North ½ of Lot 16, Lot 17 & North 10' of Lot 19, South ½ of Lot 16 & All of Lots 18 & 20, South 15' of Lot 19 & All of Lot 21, Lot 22 & North 15' of Lot 24, Lots 23 & 25 & Northwest 20' of Lot 27, south 10' of Lot 24 and All of Lot 26 & North 15' of Lot 28, Southeast 5' of Lot 27 & All of Lots 29 & 31, South 10' of Lot 28 & All of Lts 30 & 32, Block 35, McCormack's 1<sup>st</sup> Addition; Lots A, B, South 5' of Lot 5 & All of Lot 7, 9, 11, 13, 15, 17, 19, 21, 23, Front 90' of Lot 25 & North 5' of Front 90' of Lot 27, South 20' of Front 90' of Lot 27 & N 15' of Front 90' of Lot 29, South 10' of Front 90' of Lot 29 & Front 90' of Lot 31, Rear 50' of Lot 25, 27, 29, 31, Block 36, McCormack's 1<sup>st</sup> Addition; Front 70' of Lot 1 & 3, Rear 70' of Lots 1 & 3, 5, 7, 9, 11, 13, 15, 17, 19, 21, 23, 25, 27, 29, 31, Block 37, McCormack's 1<sup>st</sup> Addition; Lots 1 – 4, Lot 5 & North 8 1/3' of Lot 7, South 16 2/3' of Lot 7 & North 16 2/3' of Lot 9, 6, 8, 10, 12, South 8 1/3' of Lot 9 & All of Lot 11, 13- 32, Block 38, McCormack's 1<sup>st</sup> Addition; Lots 1 – 4, 5 & North 8 13' of Lot 7, 6, 8, S 16 2/3' of Lot 7 & North 16 2/3' of Lot 9, S 8 1/3' of Lot 9 7 all of Lot 11, 10, 12, 13-32, Block 38, McCormack's 1<sup>st</sup> Addition; Lots 1, 2, 3, 4 & North 10' of Lot 6, 5, 7, S 15' of Lot 6 & all of Lot 8, 9, 10 – 14, 15, 17, 19, 21, 16 & 18 & NW ½ of lot 20, SE ½ of Lot 20 & all of Lot 22 & 24, 23, 25, 26, 28, 30, 32, Lot 27 & North ½ of Lot 29, South ½ of Lot 29 & All of Lot 31, Block 43, McCormack's 1<sup>st</sup> Addition; Lots 1, 3 & North ½ of Lot 5, S ½ of Lot 5 & All of Lot 7, 9 & 11, 13 & 15, 17, 19, 21 & 23, 25, 27, 29 & 31, Block 44, McCormack's 1<sup>st</sup> Addition; Lots 1 – 4, Lot 5 & N 12 ½' of lot 6, S 12 ½' of Lot 6 & all of Lot 7, Lot 8 & North ½ of Lot 9, south ½ of lot 9 & all of lot 10, Lot 11, Block 45, McCormack's 2<sup>nd</sup> Addition; Lot 12 – Part of McCormack's 1<sup>st</sup> & 2<sup>nd</sup> Addition, Lots 13 & 14 – Part of McCormack's 1<sup>st</sup> & 2<sup>nd</sup> Addition, Lots 15 & 16 Part of McCormack's 1<sup>st</sup> & 2<sup>nd</sup> Addition, Block 45, Partly Lots; Lot 11 – Part of B & E 2<sup>nd</sup> and McCormack's 1<sup>st</sup> Addition, Lot 7 & 9 – Part of B & E 2<sup>nd</sup> and McCormack's 1<sup>st</sup> Addition, Lot 5 – Part of b & E 2<sup>nd</sup> and McCormack's 1<sup>st</sup> Addition, Lot 1 & 3 – part of B & E 2<sup>nd</sup> and McCormack's 1<sup>st</sup> Addition; Partly Lots; Lots 1, 2, 5, 8, 10, 12, Block 4, Part of O & T & McCormick's 1<sup>st</sup> Addition, Partly Lots; Lot A, Rear of Northeasterly 42' of Lot 2, Rear 38' of Front 98' of Lot 2, Front 60' of Lot 2, Lot B, North ½ of Lot 4, South ½ of Lot 4 & Strip of Land off the Nwrly side of Lot 6 having a width of 14' at alley & tapering to 0 width at inside sidewalk line on 4<sup>th</sup> St, Lot 5, Lot 6 Less a strip of Land off the Nwrly side having a width of 14' at alley & tapering to 0 width at the inside sidewalk line on 4<sup>th</sup> street, Block 2, Original Township; Front 105' of Lot 1, Rear

35' of Lot 1, Lot 2, North ½ of Lot 3, Lot 4, South ½ of Lot 3, Lot 5, North ½ of Lot 6, South ½ of Lot 6, Block 3, Original Townsite; Front of Southwesterly 70' of Lots 22, 24, Block 27, Budge & Eshelman's 2<sup>nd</sup> Addition; Lots 2 & 4 except south westerly 88' & Northwesterly 1' of Lot 2, Southwesterly 88' of Lots 2 & 4 & Southwesterly 88' of Northwesterly 1' of Lot 6, Southeast 24' of Lot 6, Lot & N ½ of Lot 10, South ½ of Lot 10 & All of Lot 12, Block 23, Budge & Eshelman's 2<sup>nd</sup> Addition; A 30'X90' tract lying 140' SE, of the N sec line & parallel, Unplatted Parts-Grand Forks TWP; received ¼ benefit for the entire lot.

- All BNSF property received zero benefit.
- All other lots in the district received zero benefit for 8<sup>th</sup> Ave N.

N 6<sup>th</sup> St, 9<sup>th</sup> Ave N, 10<sup>th</sup> Ave N, and 11<sup>th</sup> Ave N-

- The Commissioners assigned benefit to the district based on effective front footage, with 1.0 for frontage, and 1/3 for sideage.
- Lots 1-6 less front 3' for hwy R/W, Block 48; Alexander & Ives' Addition, received frontage along 11<sup>th</sup> Ave N and sideage along N 4<sup>th</sup> St, less 140' back from 11<sup>th</sup> Ave N.
- Rear 50' of Lots 15 & 16, Block 50; Alexander & Ives' Addition; received frontage and sideage.
- Lot 17 & all of vacated St SE adj thereto, Block 50; Alexander & Ives' Addition; received frontage and sideage, less 140' back from N Washington St.
- All of block D less that part that is located 25' E of the most E spur track C/L, Alexander & Ives' Addition, received frontage along N 6<sup>th</sup> St for 24 ft.
- Lots 2, 4, 6, 8, 10, 12, 14, 16, 18, 20, 22, 24, 26, 28, 30, & 32, Block 52; Lots 2, 4, 6, 8, 10, 12, 14, 16, 18, 20, 22, 24, 26, 28, Front 70' of Lots 30 & 32, Block 53; Lots 1 & 2, Lot 3 & N 15' of Lot 4, S 10' of Lot 4 & all of Lots 5 & 6, Lots 7-10, Lot 11 & N ½ of Lot 12, S ½ of Lot 12 & all of Lot 13, Front 80' of Lots 14-16, Block 57; Lots 1-4 less that part located 25' E of the most E spur track C/L, Front part of Lots 5-16, Rear Pt of Lots 5-16 Located 125' Erly of & Parallel to C/L of Main Track C/L less Pt 25' Erly of Most Erly Spur Track C/L, Block 58; Alexander & Ives' Addition; received frontage and sideage.
- Rear 50 ½' of Lots 2 & 4, Rear 70' of Lots 1 & 3, Block 37; Alexander & Ives' Addition; received frontage.
- Front 70' of Lot 1 & 3, Lots 5, 7, 9, 11, 13, 15, 17, 19, 21, 23, 25, 27, 44-2301-00167-000(86) Lots 29 & 31, Block 37; Lots 1-4, Lot 5 & N 8 1/3' of Lot 7, S 16 2/3' of Lot 7 & N 16 2/3' of Lot 9, Lots 6 & 8, S 8 1/3' of Lot 9 & all of Lot 11, Lots 10 & 12, Lots 13-32 Block 38; Lots 1-3, Lot 4 & N 10' of Lot 6, Lots 5 & 7, S 15' of Lot 6 & all of Lot 8, Lot 9-14, Lots 15, 17, 19, & 21, Lots 16 & 18 & NW ½ of Lot 20, SE ½ of Lot 20 & all of Lots 22 & 24, Lots 23 & 25, Lots 26, 28, 30, & 32, Lot 27 & N ½ of Lot 29, S ½ of Lot 29 & all of Lot 31, Block 43; Lots 1, Lot 3 & N ½ of Lot 5, S ½ of Lot 5 & all of Lot 7, Lots 9, 11, 13, 15, 17, 19, 21, 23, 25, 27, 29, 31, Block 44; McCormack's 1<sup>st</sup> Addition; received sideage.
- Lots 1-4, Lot 5 & N 12 ½' of Lot 6, S 12 ½' of Lot 6 & all of Lot 7, Lot 8 & N ½ of Lot 9, S ½ of Lot 9 & all of Lot 10, Lot 11, Block 45; All of said block-except the 5' X 10' strip of land bordering the SE row of 11<sup>th</sup> Ave S McCormack's 1<sup>st</sup> & 2<sup>nd</sup> Addn, Block 46, McCormack's 2<sup>nd</sup> Addition; received sideage.
- Lot 12-16 – part of McCormack's 1<sup>st</sup> & 2<sup>nd</sup> Addn, Block 45; Partly Lots; received sideage.
- NW 151' of Block E, Lot B, Block E; Lot A, Block F; Front 89 ½' of Lots 2 & 4, Lots 6, 8, 10, 12, 14, Lots 16 & N ½ of Lot 18, S ½ of Lot 18 & all of Lot 20, Lots 22, 24, 26, 28, 30,

32, Block 37; Lots 19-32 inclusive, Lots 17 & 18, Block 45; Lots 2, 4, 6, 8, 10, 12, 14, 16, 18, 20, 22, 24, 26, 28, 30, 32 Block 44; Lots A-C, Lots 6, 8, 10, 12, 14, 16, Lots 17-32, Block 49; Lot A Block E & Lot 1 & vacated street, Lots 2 7 3 fractional block 50, Lots 4-13, N 3 ½' of Lot 14, SE 21 ½' of Lot 14 & NW 6' of NW 90' of Lot 15 except triangle tract out of NE corner 11' on 5<sup>th</sup> St & 21' deep, Front 90' of SE 19' of Lot 15 & front 90' of Lot 16 also triangle tract out of NW corner of Lot 15 & NE corner of Lot 15 & NE corner of Lot 14 11' on 5<sup>th</sup> St X 21' deep, Block 50; Lots 1 & 2, Lot A, Lots B & C & Lot 8, Lots 9-20, Front part of Lots 26-28 & all of Lot 29 plus NW ½ of vac alley adj to said lots which is w/in 125' E & parallel w/the BNRN main track center line, Lot 25 & rear part of Lots 26-28 & NW ½ of alley vacated & lying contiguous to Lots 25-28 except portion to GN, Front part of Lots 21-24 plus the SW ½ of vac alley adj to said Lot 24 which is w/in 125' E & parallel w/the BNRN main track ctr line, rear part of Lots 21-24 & SE ½ of alley vacated & lying contiguous to Lot 24 except portion to Great Northern RR, Block 51; Lots 1, 3, 5, 7, 9, 11, 13, 15, 17 & 19, 21, 23 & North 10' of Lot 25, South 15' of Lot 25 & All of Lot 27, Lots 29 & 31, Block 52; Lots 1, 3, 5, 7, 9, 11, 13, 15, 17, 19, 21, 23, 25, 27, Front 80' of Lots 29 & 31, Rear 70' of Lots 30 & 32, Block 53; Rear 50' of Lots 14, 15, & 16, Rear part of Lots 19-22 Located 125' Erly & Parallel to main track C/L less than Pt 25' Erly of the Most Erly spur track C/L, Lots 17 & 18, Lots 19-22 front part less right-of-way, Lots 23-26 located 125' E & parallel to main track C/L less part 25' E of most E spur track C/L, Lots 24 & 25 rear part less right-of-way, Lot 26, Rear Part Less right of way, Block 57; Alexander & Ives' Addition; received sideage.

- All other lots in the district received zero benefit for N 6<sup>th</sup> St, 9<sup>th</sup> Ave N, 10<sup>th</sup> Ave N, or 11<sup>th</sup> Ave N.

**N 6<sup>th</sup> St, N 7<sup>th</sup> St, N 8<sup>th</sup> St-**

- Lots 2, 4, 6, 8, 10, 12, 14, 16, 18, 20, 22, 24, 26, 28, 29, 30, 32, Block 54; Front part of Lots 7-16 inclusive except rear part to GNRN; Lots 1-12, Lots 13 & 15, Lot 14 & NW ½ of Lot 16, SE ½ of Lot 16 & all of Lots 18 & 20, Lots 17, 19, 21-24, Lots 21 & 23, 25 & 27, All of Lot 26 & that portion of Lot 28 except the SE 5' and less rear 11' of NW 2' of SE 7', Front 75' of SE 5' of Lot 28 & Front 75' of Lots 30 & 32, Front 90' of Lots 29 & 31, Block 55; Alexander & Ives; received full frontage.
- Lots 2, 4, & 6, Block 4; Lots 1 & 3, Lot 2 & N ½ of Lot 4, Lot 5 & N ½ of Lot 7, S ½ of Lot 4 & all of Lot 6, S ½ of Lot 7 & all of Lot 9, Lots 8 & 10, Lots 11-14, NW 24' of Lot 15, S 1' of Lot 15 & NW 24' of Lot 17, Lots 16 & 18, SE 1' of Lot 17 & all of Lot 19, Lot 20, NE 100' of Lots 21 & 23, Block 24; Lots 1, 3, 5, 6, 7, 9, 11, Lot 13 & N ½ of Lot 15, S ½ of Lot 15 & all of Lot 17, Lots 19, 21, 23, 25, 27, 29, 31, Block 27; Front 92.5' of Lots 1 & 3, Lot 2, Lots 4-32, Block 28; Lots 2, 4, 6, 8, 10, 12, 14, 16, Lot 18 & NW 2' of Lot 20, SE 23' of Lot 20, Lots 22 & 24, Lot 26 & W ½ of Lot 28, E ½ of Lot 28 & all of Lots 30 & 32, Block 29; McCormack's 1<sup>st</sup> Addition, received full frontage.
- Lots 1, 3, 5, 7, All of Lot 9 except 3' front on 8<sup>th</sup> St & 71' long adj Lot 11 on N, SW 3' X 71' of Lot 9 & all of Lots 11 & 13, Block 14; Lot 6, Block 17; Lot 1, Lot 2 & NW 5' of Lot 4, Lot 3, S 20' of Lot 4 & Lot 6, Lot 5, Lots 7-9, Lot 10 & NW ½ of Lot 12, Lot 11 & N ½ of Lot 13, S ½ of Lot 12 & all of Lot 14, S ½ of Lot 13 & all of Lot 15, Lots 16, 18, & 20, Front 70' of Lots 22 & 24, Block 18; Lot 1, Lot 2 & N 10' of Lot 3, S 15' of Lot 3 & all of Lot 4, Lot 5-10, Front 140' of Lots 11 & 12, Block 19; SW 88' of Lots 2 & 4 & SW 88' of NW 1' of Lot 6, SE 24' of Lot 6, Lot 8 & N ½ of Lot 10, S ½ of Lot 10 & all of Lot 12, Lots

14 -19, Front 80' of Lots 21 & 23, Block 23; Budge & Eshelman's 2<sup>nd</sup> Addition, received full frontage.

- Lots 1, 3, 5, 8, 10, & 12 - part of B & E 2<sup>nd</sup> & McCormack's 1<sup>st</sup> Addn, Block 4; Lot 15, 17, 19 - Part of B & E 2<sup>nd</sup> And McKelvey's & Holcomb's Addn, Front or E 68' of Lots 21 & 23 - Part of B & E 2<sup>nd</sup> And McKelvey's & Holcomb's Addn, Block 14; Lots 2, 4, 6, 8, 10 - Part of B & E 2<sup>nd</sup> And McKelvey's & Holcomb's Addn, Block 15; Lots 1 & 3 - Part of B & E 2<sup>nd</sup> And McKelvey's & Holcomb's Addn, Lots 2 & 4 - part of B & E 2<sup>nd</sup> & McCormack's 1<sup>st</sup> Addn, Lots 5 & 7 - Part of B & E 2<sup>nd</sup> And McKelvey's & Holcomb's Addn, Lots 8, 10, 12, 14, 16 - Part of B & E 2<sup>nd</sup> And McKelvey's & Holcomb's Addn, Block 17; Lots 1, 3, 5, 7, 9, 11, 13- part of B & E 2<sup>nd</sup> & McCormack's 1<sup>st</sup> Addn, Block 23; Lots 22 & 24 - part of B & E 2<sup>nd</sup> & McCormack's 1<sup>st</sup> Addn, Block 24; Partly Lots, received full frontage.
- Lot 1 & N ½ of Lot 3, S ½ of Lot 3 & all of Lot 5, Lots 7 & 9, Lots 11-16, Lots 17 & 19 except S 10' of rear 70', Front 25' of rear 70' of S 10' of Lot 19 & NE 95' of Lots 21 & 23, Block 15; Lot 1 & N ½ of Lot 3, Lots 2, 4, 6, 8, 10, 12, Lots A & B, Lot 13 & N 3' of Lot 15, Lot 14, SE 22' of Lot 15 & all of Lot 17, Lot 16, Lot 19 & N ½ of Lot 21, E 90' of S ½ of Lot 21 & E 90' of Lot 23, Block 16; Lots 9, 11, 13, 15, 17-19, 20, 22, Front 78' of Lots 21 & 23, Lot 24, Block 17; McKelvey's & Holcomb's Addition, received full frontage.
- Lots 2, 4, 6, 8, 10, & 12, Block 5; Front 78' of Lot 2, N 2/3 of Lot 4, S 16 2/3' of Lot 4 & N 16 2/3' of Lot 6, S 33 1/3' of Lot 6, Lots 8, 10, & 12, Block 12; Original Townsite, received full frontage.
- Rear 50' of Lots 29 & 31, Rear 65' of SE 5' & rear 11' of NW 2' of SE 7' of Lot 28 & rear 65' of Lots 30 & 32, Block 55; Alexander & Ives, received sideage.
- Lots 2, 4, & 6 less R/W & all of Lots 8, 10, 12, 14, & 16, Lots A-C, Block 14; Rear or NW 70' of Lots 22 & 24, Block 18; Rear 75.8' of Lots 11 & 12, Block 19; Lots 2 & 4 except SW 88' & NW 1' of Lot 6 except SW 88' of Lot 2, Front 61' of Lots 20, 22, & 24, Front 42 ½' of rear 79' of Lots 20, 22, & 24, Rear 36 ½' of Lots 20, 22, & 24, Rear 60' of Lots 21 & 23, Block 23; Front or SW 70' of Lots 22 & 24, Adj Lots 22 & 24 less front or SW 70', Block 27; Budge & Eshelman's 2<sup>nd</sup> Addition, received sideage.
- Lots 2,3,6,8,10,12,14,16,18,20,22, 24, 26, 28, Northeasterly 70' of Lot 30 & all of Lot 32, Block 27; SW 40' of Lots 21 & 23, Block 24; Rear 47.5' of Lots 1 & 3, Block 28; McCormack's 1<sup>st</sup> Addition, received sideage.
- Lots 1 & 2, Block 1; Budge & Eshelman's 4<sup>th</sup> Addition, received sideage.
- Front 35' of Lots 18, 20, 22, & 24, Rear 35' of front 70' of Lots 18, 20, 22, & 24, Front 35' of rear 70' of Lots 18, 20, 22, & 24, Adj rear 35' of Lots 18, 20, 22, & 24, Rear 45' of rear 70' of S 10' of Lot 19 & SW 45' of Lots 21 & 23, Block 15; Front 46' of Lots 18, 20, 22, & 24, Middle 48' of Lots 18, 20, 22, & 24, Rear 46' of Lots 18, 20, 22, & 24, Rear 50' of S ½ of Lot 21 & rear 50' of Lot 23, Block 16; Rear 62' of Lots 21 & 23, Block 17; McKelvey's & Holcomb's Addition, received sideage.
- Rear 72' of Lot 21 & 23 – Part of B & E 2<sup>nd</sup> & Block 14 McKelvey's & Holcomb's Addition Partly Lots;
- Front 32' of rear 62' of Lot 2, Rear 30' of Lot 2; Original Townsite, received sideage.
- Adj Lots 1-6 inclusive & rear pt of Lots 1-16 inclusive that is 125' E of C/L of main track less that part 25' E of most E spur track C/L, Block 56; Alexander & Ives, received full frontage and sideage.

- Undivided Block 22; Budge & Eshelman's 2<sup>nd</sup> Addition, received frontage less 140' back from 5<sup>th</sup> Ave N and sideage along 5<sup>th</sup> Ave N.
- All other lots in the district received zero benefit from N 6<sup>th</sup> St, N 7<sup>th</sup> St or N 8<sup>th</sup> St.

4<sup>th</sup> Ave N, 5<sup>th</sup> Ave N, 6<sup>th</sup> Ave N, 7<sup>th</sup> Ave N-

- The Commissioners assigned benefit to the district based on effective front footage, with 1.0 for frontage, and 1/3 for sideage.
- Lots 2, 4, 6, 8, 10, 12, 14, 16, 18, 20, 22, & 24, Block 27; McCormack's 1<sup>st</sup> Addition, received sideage less 140' back from 7<sup>th</sup> Ave N, as well as full frontage.
- Rear 65' of SE 5' & rear 11' of NW 2' of SE 7' of Lot 28 & rear 65' of Lots 30 & 32, Rear 50' of Lots 29 & 31, Block 55; Alexander & Ives, received frontage.
- SW 40' of Lots 21 & 23, Block 24; NE 70' of Lot 30 & all of Lot 32, Block 27; Rear 47.5' of Lots 1 & 3, Block 28; Rear 40' of Lots 1 & 3, NE 45' of Lot 32, Block 30; Front 46' of Lots 1, 3, 5, & 7, Rear 39' of Front 85' of SE 15' of rear 55' of Lots 1, 3, 5, & 7, Rear 55' of Lots 1 & 3 and rear 55' of NW 10' of Lot 5, Rear 64' of Lots 29 & 31, Rear 50' of Lots 30 & 32, Block 31; Rear 50' of Lots 25, 27, 29, & 31, Block 36; McCormack's 1<sup>st</sup> Addition, received frontage.
- Front 70' of Lots 22 & 24, Rear or NE 70' of Lots 22 & 24, Block 18; Rear 75.8' of Lots 11 & 12, Block 19; Lots 2 & 4 except SW 88' & NW 1' of Lot 6 except SW 88' of Lot 2, Front 61' of Lots 20, 22, & 24, Front 42 ½' of rear 79' of Lots 20, 22, & 24, Rear 36 ½' of Lots 20, 22, & 24, Rear 60' of Lots 21 & 23, Block 23; Front or SW 70' of Lots 22 & 24, Adj Lots 22 & 24 less the front or SW 70', Block 27; Budge & Eshelman's 2<sup>nd</sup> Addition, received frontage.
- Lots 1 & 2, Block 1; Budge & Eshelman's 4<sup>th</sup> Addition, received frontage.
- Rear 38' of front 98' of Lot 2, Rear of NW 42' of Lot 2, Rear 70' of Lot 12, Block 2; Rear 35' of Lot 1, Rear 52' of Lot 11, Block 3; Lot 1 except front 80', Lot B, Rear part 45 x 50' of Lot 12, Block 6; Rear 63.6' of Lot 2, Block 7; Rear 55' of Lot 1, Block 11; Rear 52' of Lot 1, Front 32' of rear 62' of Lot 2, Rear 30' of Lot 2, Block 12; Original Townsite, received frontage.
- Rear 62' of Lots 21 & 23, Block 17; McKelvey's & Holcomb's Addition, received frontage.
- Lot 2 & NW 21' of Lot 4, SE 4' of Lot 4 & all of Lot 6, Lots 8, 10, 12, 14, 16, 18, 20, 22, 24, 26, 28, 30, & 32, Block 36; Lots 1-32, Block 54; Lots 1-12, Lots 13 & 15, Lot 14 & NW ½ of Lot 16, S ½ of Lot 16 & all of Lot 18 & 20, Lots 17, 19, 21-24, Lots 25 & 27, All of Lot 26 & that portion of Lot 28 except the SE 5' and less rear 11' of NW 2' of SE 7', Front 75' of SE 5' of Lot 28 & Front 75' of Lots 30 & 32, Front 90' of Lots 29 & 31, Block 55; Alexander & Ives, received sideage.
- Lots 2, 4, & 6, Block 4; Lots 1 & 3, Lot 2 & N ½ of Lot 4, S ½ of Lot 4 & all of Lot 6, Lot 5 & N ½ ½' of Lot 7, Lot 8, S 12 ½' of Lot 7 & all of Lot 9, Lot 10-14, NW 24' of Lot 15, SE 1' of Lot 15 & NW 24' of Lot 17, Lots 16 & 18, S 1' of Lot 17 & all of Lot 19, Lot 20, NE 100' of Lots 21 & 23, Block 24; Lots 1, 3, 5, 7, 9, 11, Lots 13 & N ½ of Lot 15, S ½ of Lot 15 & all of Lot 17, Lots 19, 21, 23, 25-29, 31, Lots 26 & 28, Block 27; Front 92.5' of Lots 1 & 3, Lot 2, Lots 4-32, Block 28; Lots 1-3, Lots 4 & 6, Lots 5 & 7 & NW 2' of Lot 9, Lots 8 & 10, SE 23' of Lot 9 & all of Lot 11, Lots 12-17, Lot 18 & NW 2' of Lot 20, SE 23' of Lot 20, Lot 19 & N 10' of Lot 21, S 15' of Lot 21 & all of Lot 23, Lots 22 & 24, Lot 25 & N 9' of Lot 27, Lot 26 & W ½ of Lot 28, S 16' of Lot 27 & N 17' of Lot 29, E ½ of Lot 28 & all

of Lots 30 & 32, SE 8' of Lot 29 & all of Lot 31, Block 29; Front 100' of Lots 1 & 3, Lots 2 & 4, Lots 5-17, Lots 18, 20, 22, & 24, Lots 19 & 21, Lot 23 & N ½ of Lot 25, S ½ of Lot 25 & all of Lot 27, Lot 26, Lots 28-31, SW 95' of Lot 32, Block 30; Lots 2, 4, 6, Lots 8-12, Lots 13 & N ½ of Lot 15, Lots 14 & 16, S ½ of Lot 15 & all of Lot 17 & N ½ of Lot 19, Lots 18, 20, S ½ of Lot 19 & all of Lots 21 & 23, Lots 22 & 24, Lots 25-28, Front 76' of Lots 29 & 31, Front 90' of Lots 30 & 32, Block 31; Lots 1-8, Lots 9 & 11, Lots 10, 12, & N ½ of Lot 14, S ½ of Lot 14 & N ½ of Lot 16, Lots 13 & 15, S ½ of Lot 16 & all of Lots 1/ & 20, Lot 17 & N 10' of Lot 19, S 15' of Lot 19 & all of Lot 21, Lot 22 & N 15' of Lot 24, Lots 23 & 25 & NW 20' of Lot 27, S 10' of Lot 24 & all of Lot 26 & N 15' of Lot 28, SE 5' of Lot 27 & all of Lots 29 & 31, S 10' of Lot 28 & all of Lots 30 & 32, Block 35; Lots A & B, S 5' of Lot 5 & all of Lot 7, Lots 9, 11, 13, 15, 17, 19, 21, 23, Front 90' of Lot 25 & N 5' of front 90' of Lot 27, S 20' of front 90' of Lot 27 & N 15' of front 90' of Lot 29, S 10' of front 90' of Lot 29 & front 90' of Lot 31, Block 36; McCormack's 1<sup>st</sup> Addition, received sideage.

- Lots 1, 3, 5, 7, All of Lot 9 except 3' front on 8<sup>th</sup> St & 71' long adj Lot 11 on N, SW 3' x 71' of Lot 9 & all of Lots 11 & 13, Block 14; Lot 6, Block 17; Lot 1, Lot 2 & NW 5' of Lot 4, Lot 3, S 20' of Lot 4 & all of Lot 6, Lot 5, Lots 7-9, Lot 10 & NW ½ of Lot 12, Lot 11 & N ½ of Lot 13, SE ½ of Lot 12 & all of Lot 14, S ½ of Lot 13, & all of Lot 15, Lot 16, Lots 18 & 20, Block 18; Lot 1, Lot 2 & N 10' of Lot 3, S 15' of Lot 3 & all of Lot 14, Lots 5-10, Front 140' of Lots 11 & 12, Block 19; SW 88' of Lots 2 & 4 & SW 88' of NW 1' of Lot 6, SE 24' of Lot 6, Lot 8 & N ½ of Lot 10, S ½ of Lot 10 & all of Lot 12, Lots 14-18, Front 80' of Lots 21 & 23, Block 23; Budge & Eshelman's 2<sup>nd</sup> Addition, received sideage.
- Lot 1 & N ½ of Lot 3, S ½ of Lot 3 & all of Lot 5, Lots 7 & 9, Lots 11-16, Lots 17 & 19 except S 10' of rear 70', Front 25' of rear 70' of S 10' of Lot 19 & NE 95' of Lots 21 & 23, Block 15; Lot 1 & N ½ of Lot 3, Lots 2 & 4, Lots A & B, Lots 6, 8, 10, 12, 14 Lot 13 & N 3' of Lot 15, Lot 16, SE 22' of Lot 15 & all of Lot 17, Lot 19 & N ½ of Lot 21, E 90' of S ½ of Lot 21 & E 90' of Lot 23, Block 16; Lots 9 & 11, 13 & 15, 17, 18, 19, 20 & 22, Front 78' of Lots 21 & 23, 24, Block 17; McKelvey's & Holcomb's Addition, received sideage.
- Lots 1, 3, 5, 8, 10, & 12 - part of B & E 2<sup>nd</sup> & McCormack's 1<sup>st</sup> Addn, Block 4; Lots 15, 17, & 19 - Part of B & E 2<sup>nd</sup> And McKelvey's & Holcomb's Addn, Lots 1 & 3 McKelvey's & Holcomb's & McCormack's 1<sup>st</sup>, Block 17; Front or E 68' of Lots 21 & 23 - Part of B & E 2<sup>nd</sup> And McKelvey's & Holcomb's Addn, Block 14; Lots 2, 4, 6, 8, & 10 - Part of B & E 2<sup>nd</sup> And McKelvey's & Holcomb's Addn, Block 15; Lots 2 & 4 Part of B & E 2<sup>nd</sup> & McCormacks 1<sup>st</sup> Addn, Block 17; Lots 5 & 7 Part of McKelvey's & Holcomb's & McCormack's 1<sup>st</sup>, Block 17; Lots 8, 10 & 12, 14 & 16, Part of B & E 2<sup>nd</sup> & McKelvey's & Holcomb's Addition, Block 17; Lots 1, 3, 5, 7, 9, 11, 13 - part of B & E 2<sup>nd</sup> & McCormack's 1<sup>st</sup> Addn, Block 23; Lots 22 & 24 Part of B & E 2<sup>nd</sup> & McCormack's 1<sup>st</sup> Addition, Block 24; Partly Lots, received sideage.
- Lots A & B, Front 60' of Lot 2, N ½ of Lot 4, , S ½ of Lot 4 & strip of land off the NW side of Lot 6 having a width of 14' at alley & tapering to 0 width at inside sidewalk line on 4<sup>th</sup> St, Lot 5, Lot 6 less a strip of land off the NW side having a width of 14' at alley & tapering to 0 width at the inside sidewalk line on 4<sup>th</sup> St., Lots 8 & 10, Front 70' of Lot 12, Block 2; Front 105' of Lot 1, Lot 2, N ½ of Lot 3, S ½ of Lot 3, Lots 4, 5, N ½ of Lot 6, S ½ of Lot 6, NW 25' of Lot 7, SE 25' of Lot 7, N ½ of Lot 8, S ½ of Lot 8, Lot 9, Lots 10 & 12, N 25' of E 80' of Lot 11, S 25' of E 80' & W 8' of E 88' of Lot 11, Block 3; Lots 7, 9, & 11, Block 4; Lots 1-12, Block 5; Front 80' of Lot 1, Lot 2, N ½ of Lot 3, S ½ of Lot 3, Lots 4-6, 8, 10, Front 100' of Lot 11, Front part 50 x 95' of Lot 12, Lot A, Block 6; Front 76.4' of

Lot 2, Lots 4, 6, 8, 10, 12, Block 7; Lots 2, 4, 6, 8, 10 & 12, Block 10; Front 85' of Lot 1, NW 36' of Lot 2, Lot 3, S 14' of Lot 2 & N 19' of Lot 4, S 31' of Lot 4, N ½ of Lot 5, S ½ of Lot 5 & N 3' of Lot 7, N 34' of Lot 6, S 16' of Lot 6 & all of Lots 8, 10, & 12, S 47' of Lot 7, Block 11; Front 88' of Lot 1, Front 78' of Lot 2, Lot 3, N 2/3 of Lot 4, S 16 2/3' of Lot 4 & N 16 2/3' of Lot 6, Lot 5, S 33 1/3' of Lot 6, Lot 7, Lots 8, 10, & 12, N ½ of Lot 9, S ½ of Lot 9, E 83' front of Lot 11, Block 12; Original Townsite, received sideage.

- Adj Lots 1-6 inclusive & rear pt of Lots 1-16 inclusive that is 125' E of C/L of main track less that part 25' E of most E spur track C/L, Block 56; Alexander & Ives, received frontage, as well as sideage, less 140' back from 8<sup>th</sup> Ave N and 140' back from 7<sup>th</sup> Ave N.
- Front part of Lots 7-16 inclusive except rear part to GNR, Block 56; Alexander & Ives, received frontage, as well as sideage, less 140' back from 7<sup>th</sup> Ave N.
- Undivided Block 22; Budge & Eshelman's 2<sup>nd</sup> Addition, received frontage, as well as sideage, less 140' back from 5<sup>th</sup> Ave N.
- Lots 2, 4, & 6 less R/W & all of Lots 8, 10, 12, 14, & 16, Block 14; Budge & Eshelman's 2<sup>nd</sup> Addition, received frontage, as well as sideage, less 140' back from 4<sup>th</sup> Ave S.
- All other lots in the district received zero benefit from 4<sup>th</sup> Ave N, 5<sup>th</sup> Ave N, 6<sup>th</sup> Ave N, 7<sup>th</sup> Ave N.
- 

#### 4<sup>th</sup> Ave N and N 11<sup>th</sup> St-

- The Commissioners assigned benefit to the district based on effective front footage, with 1.0 for frontage, and 1/3 for sideage.
- N 45' of Lot 6, 65' across Lot 6 beginning 45' from N end of Lot 6, Rear 30' of Lot 6, Block E; Lot 15 & E ½ of Lot 17, W ½ of Lot 17 & all of Lot 19, Lots 21 & 23, Block F; Lots 1, 3, 5, 7, 9, 11, 13, 15, Lot 17 & E 5' of Lot 19, W 20' of Lot 19 & all of Lots 21 & 23, Block G; Lots 8, 10, 12, 14, 16, 18, 20, 22, & 24, Block H; Lot 14 & E ½ of Lot 16, W ½ of Lot 16 & all of Lot 18, Block I; Budge & Eshelman's 2<sup>nd</sup> Addition, received full frontage.
- Adj, A piece 20' x 25' in the NW corner of Lot 4, Block E; Lots 2, 4, 6, 8, Lot 10 & E 15' of Lot 12, Block F; Front 70' of Lots 2, 4, & 6, Rear 70' of Lots 2, 4, & 6, Block H; Lots 1, 3, 5, 7, 9, 11, Front 75' of Lots 20, 22, & 24, Rear 65' of Lots 20, 22, & 24, Block I; Lots 2-4, W ½ of Lot 5 & all of Lot 7, Lots 9, 11, 13, 15, 17, 19, 21, & 23, Block J; Budge & Eshelman's 2<sup>nd</sup> Addition, received sideage.
- Lots 1 & 2, Lots 3 & 4 less a piece 20' x 25' in NW corner, Lots 5 & 7, Block E; Lots 1, 3, 5, 7, 9, 11, & 13, Block F; S 50' of Lots 2, 4, 6, & 8, N 90' of Lots 2 & 4, N 90' of Lots 6 & 8, Lots 10 & 12, Block I; Lots 6, 8, 10, 12, 14, 16, 18, 20, & 22, Block J; Budge & Eshelman's 2<sup>nd</sup> Addition, received full frontage and sideage.

#### b. Project #8884.2, District #793.2 – Mill & Overlay for Minnesota Ave (S 4<sup>th</sup> St to mid-block between S 5<sup>th</sup> St and S 6<sup>th</sup> St)

Project location area consists of area on Minnesota Ave (S 4<sup>th</sup> St to mid-block between S 5<sup>th</sup> ST and S 6<sup>th</sup> ST)

To serve the following platted lands to the City of Grand Forks: Lots 2 - 5, Block 1, Central Park Resubdivision; Lots 3 – 6, B, Auditor's Sub- division No. 4; Lots 2 - 6, Block 1, Auditors

Resubdivision No. 37; Lot A, Block 1, Auditor's Resubdivision No. 50; Lot 9 & 11, Block 1, Bartholomew's Addition; Lots 1, 3, 5, 7, 9, 11, Block 1, Hawkin's Addition; Lot 1, Rear 48'7 1/2" of Lot 2, Front 91' 4 1/2" of Lot 2, Block 1; Lot 1, 3, 5, 7, 9, 11, Lots A – C, S 17' of Lot 10 & all of Lot 12, Block 2; Lots 1 & 3 & 1/2 of vacated alley adjacent thereto, Lot 5 & North 1/2 of Lot 6 & 1/2 of vacated alley adjacent thereto, South 1/2 of Lot 6 & All of Lot 7 & 1/2 of vacated alley adjacent thereto, Lot 8, Block 3; Lot C, Block 4, Hubert's Addition; Lots 1 – 9, Northwesterly 40' of Lot 10, Front 84'6" of Lot 11, Rear 55'6" of Lot 11, Southeasterly 10' of Lot 10 & All of Lot 12, Block 4; Lot 2 & Northwest 10' of Block 4, Southeast 40' of Lot 4, Lot 6, Lot 8 & North 1/2 of Lot 10, South 1/2 of Lot 10 & All of Lot 12, Lot A, C, D, E, F, G, H, Block 9, Viets; Lot 5, Block, Yoder's Sub-Division.

The benefits received from the project are for access, both for property and fire protection, dust suppression, pedestrian accommodations and providing some drainage control. Based on these factors, we anticipate that the benefits will exceed the cost of the project.

The map of the project was presented by the Finance and Engineering Departments.

**Motion by Fossen, second Poykko, to assign benefit, pending a positive cost benefit analysis is presented by city staff at the time of bid, as follows:**

- **Commissioners assigned benefit to the district using square footage, with 1.0 for frontage and 1/4 for sideage.**
  - **Lot 5, Block 1, Yoder's Sub-Division; Lot 6, Block 1, Auditor's Resubdivision No. 37; Lot 5, Block 1, Central Park Resubdivision; received zero benefit.**
  - **Lot 4, Block 1, Central Park Resubdivision, received sideage for 11,482.71 sq ft and zero benefit for the remaining area of the lot.**
  - **Rear 48' 7 1/2" of Lot 2, Block 1, Hubert's Addition, received full benefit.**
  - **All other lots in the district received sideage.**
- c. Project #8884.3, District #793.3 – Mill & Overlay for S 3rd St (Kittson Ave to RR), S 4th St (Demers to Kittson Ave) & Kittson Ave (S 3rd St to S 4th St)**

Project location area consists of area on s 3<sup>RD</sup> St (Kittson Ave to RR), S 4<sup>th</sup> St (Demers to Kittson Ave), Kittson Ave (S 3<sup>rd</sup> St to S 4<sup>th</sup> St)

To serve the following platted lands to the City of Grand Forks: Lot 34 Less South easterly 10' of Westerly 1933.2' fronting on N 3<sup>rd</sup> St, Block 1, Auditor's Resubdivision No. 15; Lots 1 - 4, Block 1, Auditor's Resubdivision No. 29; Northeast 65' of Lots 2 & 4 & Northwest 15' of Northeast 65' of Lot 6, Southwest 75' of Lots 2 & 4, North 1/2 of Lot 1, South 1/2 of Lot 1, Lot 3 & North 1/2 of Lot 5, Lot 6 except a strip 15 x 65' in Northeast corner & North 1/2 of Lot 8, South 1/2 of Lot 5 & North 1/2 of Lot 7, south 1/2 of Lot 7 & North 1/2 of Lot 9, South 1/2 of Lot 9 & North 1/2 of Lot 11, south 1/2 of Lot 11 & North 1/2 of Lot 13, South 1/2 of Lot 13 all of Lot 15 except the R 18' & A 2.85' Strip of vacated Kittson Ave Adj to Lot 15, South 1/2 of Lots 8 & 10 & North 1/2 of Lot 12, South 1/2 of Lot 12, Rear 24' 9 1/4 of Lot 14 & 16 Plus a 2.85' strip of vacated Kittson Ave adjacent to said lots, Rear 18' & Vacated Street of Lot 18, Rear 75' & 2 3/4 of front 115' & 2 3/4 of lots 14 & 16, Front 40' of Lots 14 & 16 plus a vacated 2.85' strip of Kittson Ave adjacent to said lots, Block 26; Lots A, C & D, Block 27; Lot 1 less BN right-of-way, That part of Northeast 1/2 of Lot 2 being North of GN right – of way, Lot 3, Lot 5 less

BN right-of-way, that part of West ½ of Lots 2 lying West of GN right-of-way, East 37' of Lot 4 Less right-of-way, West 63' of Lot 4 Less right-of-way, Lots 1 & 5 & part of vacated cul-de-sac turnaround plus northwest ½ of Lot 7 less town of grand forks 1<sup>st</sup> resub; Lots 2, 4 & 6 plus that part of lot 2 southeast of railroad right-of-way, Block 31; Lot 2 & North 40' of Lot 4 & southerly ½ of vacated Bruce Ave adjacent to Lot 2, Southeast 10' of Lot 4 & all of Lot 6, South ½ of Lot 7 & North 6' of North ½ of Lot 9, Lot 8, South 1/2 of Lot 9, South easterly 24'6' of North westerly 25' of Lot 9, 10 - 12, Block 33, Original Townsite; Lots 1 – 3, Block1, Town of Grand Forks First Resubdivision; Front 80' of Lot 1, Front 47' of Rear 50' of Lot 1, North ½ of Lot 3 less 6' for alley, South ½ of Lot 3 less 6' for alley, Lot 2 & 4 less rear 6' for Alley, Block 2, Viets.

The benefits received from the project are for access, both for property and fire protection, dust suppression, pedestrian accommodations and providing some drainage control. Based on these factors, we anticipate that the benefits will exceed the cost of the project.

The map of the project was presented by the Finance and Engineering Departments.

**Motion by Fossen, second Poykko, to assign benefit, pending a positive cost benefit analysis is presented by city staff at the time of bid, as follows:**

**S 4<sup>th</sup> St-**

- **Commissioners assigned benefit to the district using square footage, with 1.0 for frontage and ¼ for sideage.**
- **Lot A, Block 27, Original Townsite, received full benefit for 2,625 sq ft and sideage for the remaining area of the lot**
- **Lots C & D, Block 27, Original Townsite, received full benefit for 140' back from S 4<sup>th</sup> St and sideage for the remaining are of the Lot.**
- **SW 75' of Lots 2 & 4, NE 65' of Lots 2 & 4 and NW 15' of NW 65' of Lot 6, Front 40' of Lots 14 & 16 plus vac 2.85' strip of Kittson Ave adjacent to said lots, Rear 75' & 2 ¾" of front 115' & 2 ¾" of Lots 14 & 16, Rear 24' 3 ¼" of Lots 14 & 16 Plus a 2.85' strip of vacated Kittson Ave adjacent to said lots, Block 26, Original Townsite, received sideage for the entire area of the lot.**
- **Lot 6 except strip 15' x 65' in NE corner, S ½ of Lots 8 & 10 & N ½ of Lot 12, S ½ of Lot 12, Block 26, Original Townsite, received full benefit for the entire area of the lot.**
- **All other lots in the district received zero benefit from S 4<sup>th</sup> St.**

**Kittson Ave-**

- **Commissioners assigned benefit to the district using square footage, with 1.0 for frontage and ¼ for sideage.**
- **Rear 18' & Vacated Street of Lot 15, Front 40' of Lots 14 & 16 plus vac 2.85' strip of Kittson Ave adjacent to said lots, Rear 75' & 2 ¾" of front 115' & 2 ¾" of Lots 14 & 16, Rear 24' 3 ¼" of Lots 14 & 16 Plus a 2.85' strip of vacated Kittson Ave adjacent to said lots, Block 26, Lot 1 less BN right-of-way, That part of NE ½ of Lot 2 being N of GN R/W, That part of W ½ of Lot 2 lying W of GN R/W, E 37' of Lot 4 less R/W, W 63' of Lot 4 less R/W, Block 31, Original Townsite, received full benefit for the entire area of the lot.**
- **N ½ of Lot 1, S ½ of Lot 1, NE 65' of Lots 2 & 4 & NW 15' of NE 65' of Lot 6, SW 75' of Lots 2 & 4, Lot 3 & N ½ of Lot 5, S ½ of Lot 5 & N ½ of Lot 7, Lot 6 except strip 15' x 65'**

**in NE corner, S ½ of Lot 7 & N ½ of Lot 9, S ½ of Lots 8 & 10 and N ½ of Lot 12, S ½ of Lot 9 & N ½ of Lot 11, S ½ of Lot 11 & N ½ of Lot 13, S ½ of Lot 12, South ½ of Lot 13 all of Lot 15 except the R 18' & A 2.85' Strip of vacated Kittson Ave Adj to Lot 15, Block 26, Lot 3, Lot 5 less BN right-of-way, Block 31, Lot 2 & N 40' of Lot 4 & S ½ of vac Bruce Ave adj to Lot 2, SE 10' of Lot 4 & all of Lot 6, Lot 8, S ½ of Lot 7 & N 6' of N ½ of Lot 9, SE 24'6" of NW 25' of Lot 9, S ½ of Lot 9, Lots 10-12, Block 33, Original Townsite; Lots 1-3, Block 1, Town of Grand Forks First Resubdivision; received sideage for the entire area of the lot.**

- **All other lots in the district received zero benefit from Kittson Ave.**

#### **S 3<sup>rd</sup> St-**

- **Commissioners assigned benefit to the district using square footage, with 1.0 for frontage and ¼ for sideage.**
- **Lots 3, Lot 5 less BN right-of-way, Block 31, Original Townsite, received full benefit for the entire area of the lot.**
- **Lot 2, Block 1, Auditor's Resubdivision No. 29, received full benefit to the extent of the project on S 3<sup>rd</sup> St and zero benefit for the remaining area of the lot.**
- **Lot 1 less BN right-of-way, Block 31, Original Townsite, received sideage for the entire area of the lot.**
- **All other areas in the district received zero benefit from S 3<sup>rd</sup> St.**

#### **d. Project #8884.4, District #793.4 – Mill & Overlay for Spruce Ct and 32nd Ave S (Belmont Rd to E Elmwood Dr)**

Project location area consists of area on Spruce Ct & 32<sup>nd</sup> Ave S (Belmont Rd to E Elmwood Dr)

To serve the following platted lands to the City of Grand Forks: Lots 1 & 2, Block 1, Auditors Resubdivision No. 49; Lot 3 & 4, Block 1, Brown's Addition; Lots 6 - 9, 12 – 17, Block 1; Lots 4 - 10, Block 2, Flaats's Addition; Lots 3, 4, Flaats's 4<sup>th</sup> Addition; Lot 1, Sprucewood Addition; Lots D, E & F, Sprucewood 2<sup>nd</sup> Resubdivision.

The benefits received from the project are for access, both for property and fire protection, dust suppression, pedestrian accommodations and providing some drainage control. Based on these factors, we anticipate that the benefits will exceed the cost of the project.

The map of the project was presented by the Finance and Engineering Departments.

**Motion by Fossen, second Poykko, to assign benefit, pending a positive cost benefit analysis is presented by city staff at the time of bid, as follows:**

- **Commissioners assigned benefit to the district using effective front footage, with 1.0 for frontage and 1/3 for sideage.**
- **Lots 8-10, Block 2, Flaats's Addition, received full frontage.**
- **Lot D, Sprucewood Addition; Lots E & F, Sprucewood 2<sup>nd</sup> Resubdivision, received full frontage and sideage.**

- **Lots 3 & 4, Block 1, Brown's Addition; Lots 6-9 and 12-17, Block 1; Lots 4-7, Block 2, Flaats' Addition; Lot 1, Sprucewood Addition; Lots 3& 4, Flaats' 4<sup>th</sup> Addition, received sideage.**
- **Lots 1 & 2, Block 1, Auditor's Resubdivision No. 49, received zero benefit.**

**e. Project #8884.5, District #793.5 – Mill & Overlay for N 8th St (1st Ave N to 2nd Ave N)**

Project location area consists of area on N 8<sup>th</sup> St (1<sup>st</sup> Ave N to 2<sup>nd</sup> Ave N)

To serve the following platted lands to the City of Grand Forks: Lots 4 - 7, A, B, C, D & E, Block 1, Larry's Resubdivision; Partly Lots (Griggs & B&E) Lot 1,3,5,7,9,11,13 & 15 & ½ of Vacated Alley & All of Adjacent Alley & That Part of Vacated N 9<sup>th</sup> St between these lots, Blocks 5 & 6, Partly Lots; Lots B, C, D, E, Block 2, Renewal Resubdivision 5.

The benefits received from the project are for access, both for property and fire protection, dust suppression, pedestrian accommodations and providing some drainage control. Based on these factors, we anticipate that the benefits will exceed the cost of the project.

The map of the project was presented by the Finance and Engineering Departments.

**Motion by Fossen, second Poykko, to assign benefit, pending a positive cost benefit analysis is presented by city staff at the time of bid, as follows:**

- **Commissioners assigned benefit to the district using square footage, with 1.0 for frontage and ¼ for sideage.**
- **Lot D, Block 2, Renewal Resub-Division 5 received full benefit for the first 140' or 12,623.80 sq ft and sideage benefit for the remainder of the lot.**
- **Partly Lots (Griggs & B&E) Lot 1, 3, 5, 7, 9, 11, 13 & 15 & ½ of vac alley & all of adj alley & that part of vac N 9<sup>th</sup> St btwn these lots, Blocks 5 & 6, Partly Lots, received full frontage for 140' back from N 8<sup>th</sup> St and sideage for the remaining area of the lots.**
- **Lot B, Block 1, Larry's Resubdivision received full frontage for 140' back from N 8<sup>th</sup> St and sideage for the remaining area of the lot.**
- **Lot E, Block 2, Renewal Resub-Division 5, received frontage for 140' back from N 8<sup>th</sup> St to the extent of the project limits or 9,794.40 sq ft and received zero benefit for the remaining area of the lot.**
- **Lots B & C, Block 2, Renewal Resub-Division 5; Lots 5-7, Block 1, Larry's Resubdivision, received sideage to the extent of the project limits.**
- **Lots A, C, D, E, and 4, Block 1, Larry's Resubdivision, received sideage for the entire area of the lot.**

### **3. Other**

#### **a. Special Assessment Commission policy discussion**

Commissioners discussed availability for a future meeting with City Attorney, Dan Gaustad, to discuss policy revisions.

**Meeting adjourned at 2:50 p.m.**

Respectfully submitted,

Stefanie Coleman  
Accountant – Special Assessments

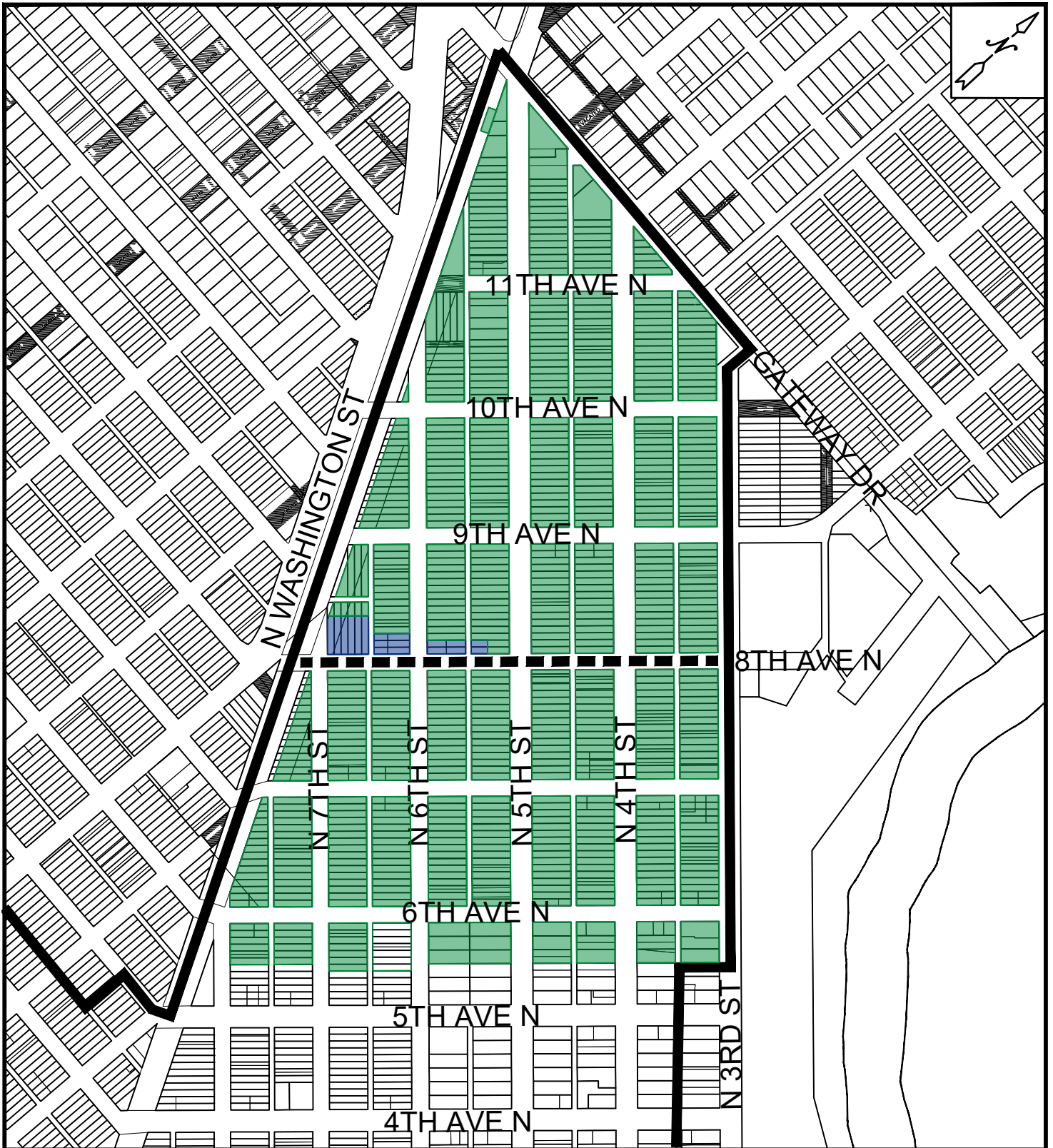

## 2025 MILL & OVERLAY NEAR NORTH NEIGHBORHOOD

### LEGEND

PROJECT # 8884.1



ASSESSMENT DISTRICT  
BOUNDARY



1.0 BENEFIT

DISTRICT # 793.1



PROJECT LIMITS



0.25 BENEFIT

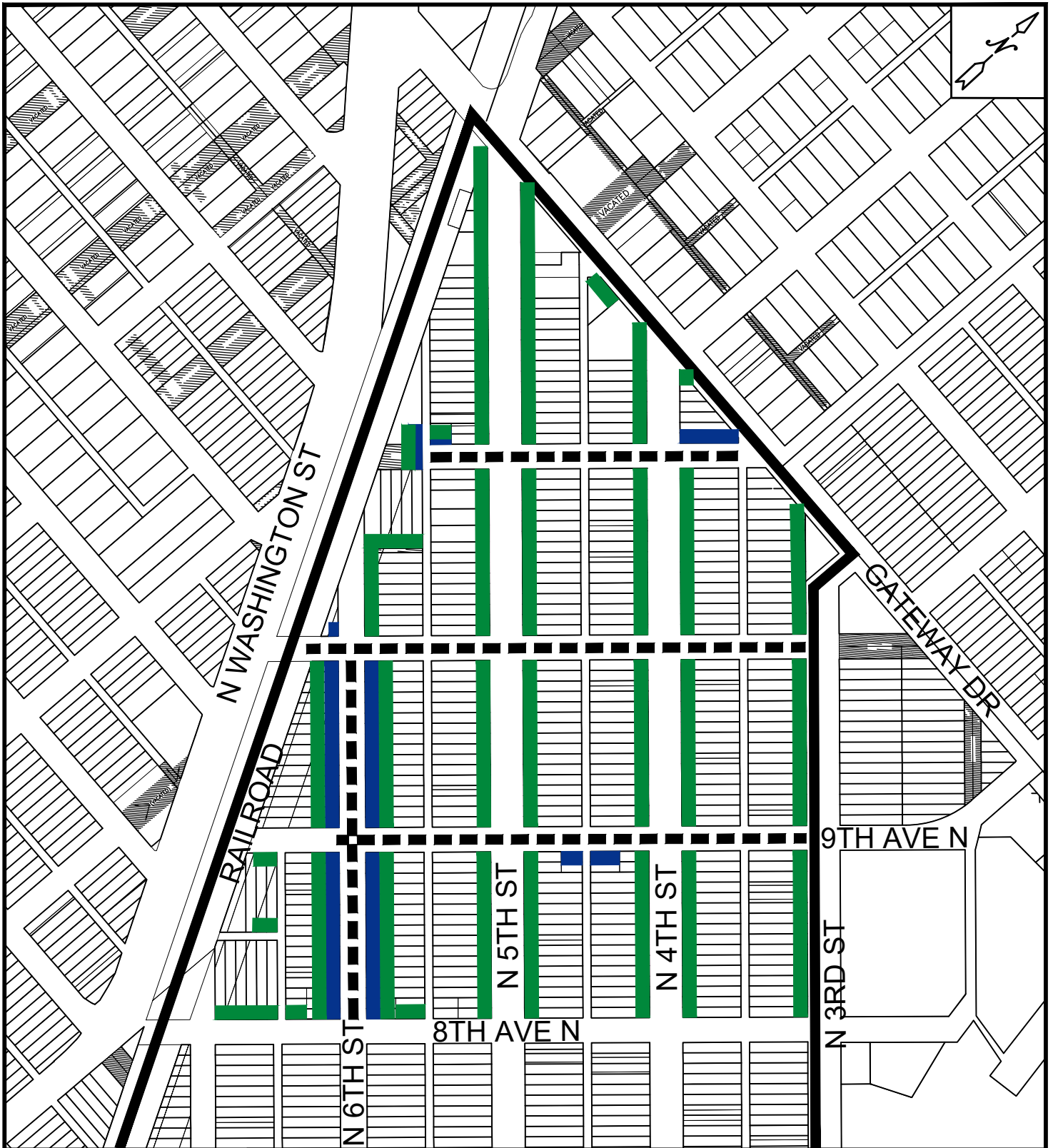

## 2025 MILL & OVERLAY NEAR NORTH NEIGHBORHOOD

### LEGEND

PROJECT # 8884.1

DISTRICT # 793.1



ASSESSMENT DISTRICT  
BOUNDARY



PROJECT LIMITS



1.0 FRONTAGE



0.33 SIDEAGE



## 2025 MILL & OVERLAY NEAR NORTH NEIGHBORHOOD

### LEGEND

PROJECT # 8884.1



ASSESSMENT DISTRICT  
BOUNDARY



1.0 FRONTAGE

DISTRICT # 793.1



PROJECT LIMITS



0.33 SIDEAGE

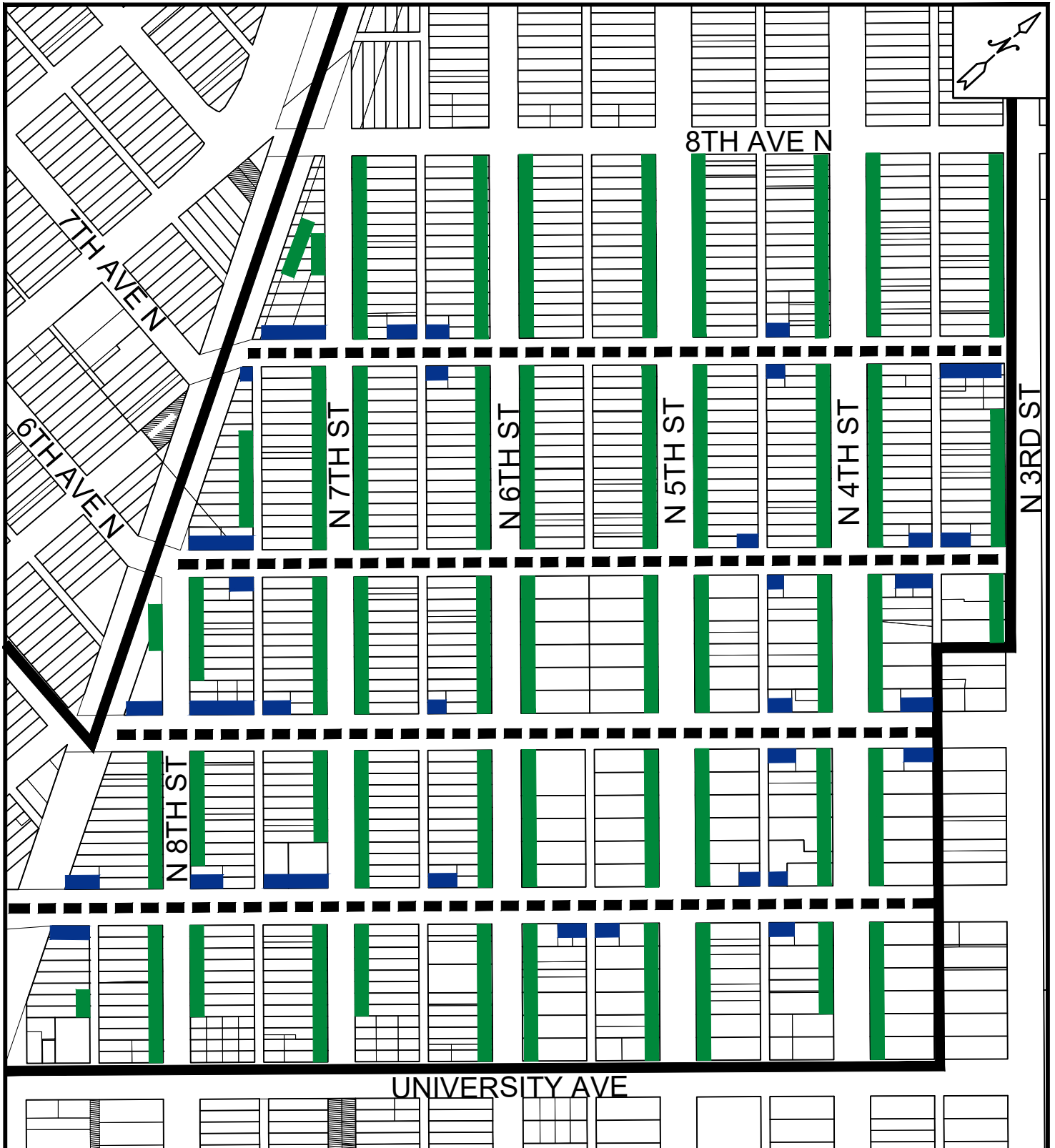

## 2025 MILL & OVERLAY NEAR NORTH NEIGHBORHOOD

### LEGEND

PROJECT # 8884.1

DISTRICT # 793.1



ASSESSMENT DISTRICT  
BOUNDARY



PROJECT LIMITS



1.0 FRONTAGE



0.33 SIDEAGE



## 2025 MILL & OVERLAY NEAR NORTH NEIGHBORHOOD

### LEGEND

PROJECT # 8884.1



ASSESSMENT DISTRICT  
BOUNDARY



1.0 FRONTAGE

DISTRICT # 793.1



PROJECT LIMITS



0.33 SIDEAGE

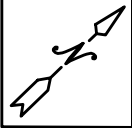
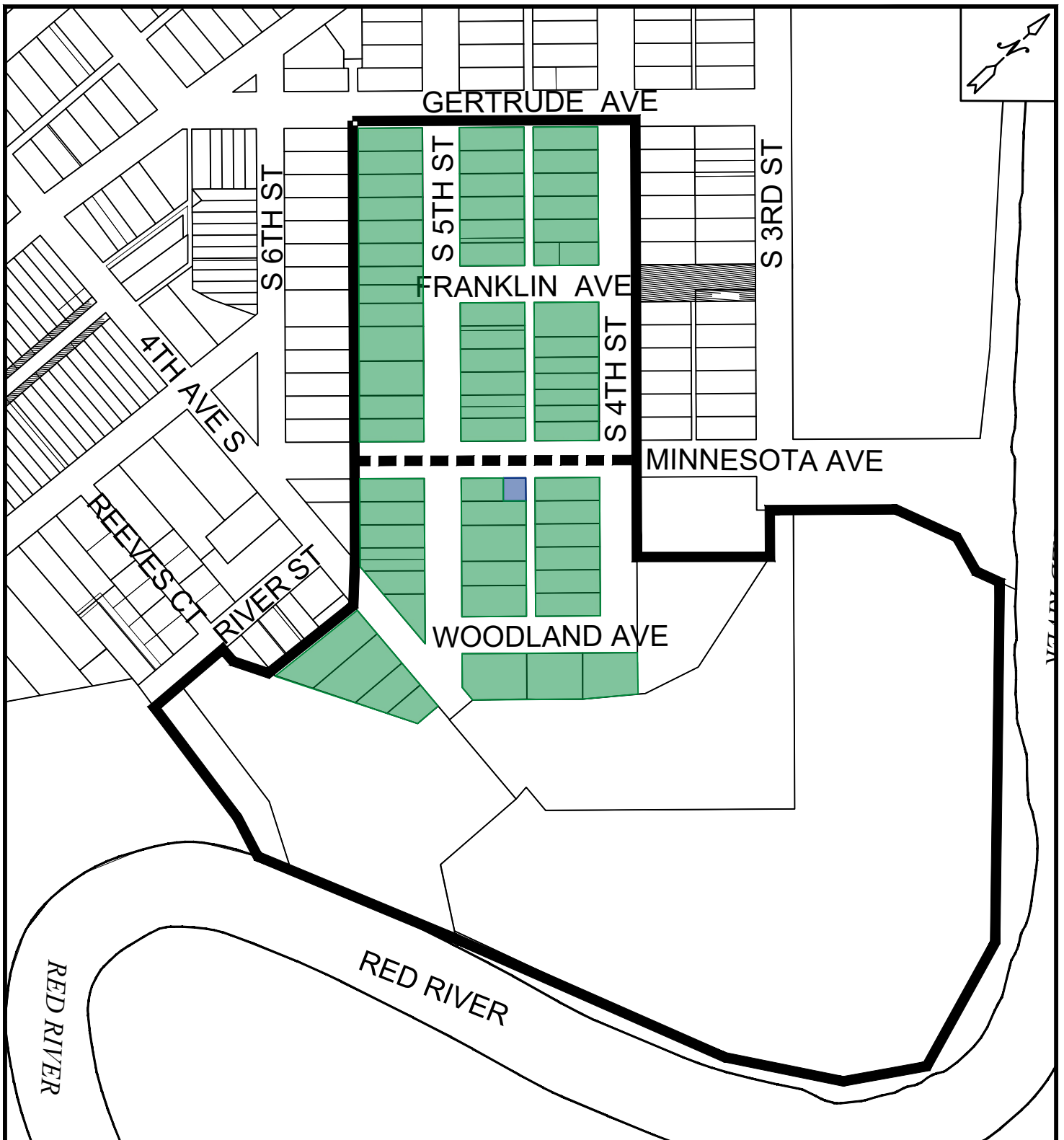



**2025 MILL & OVERLAY  
MINNESOTA AVE**



**(S 4TH ST TO MID-BLOCK OF S 5TH ST & S 6TH ST)**

LEGEND

PROJECT # 8884.2

DISTRICT # 793.2

-  ASSESSMENT DISTRICT BOUNDARY
-  PROJECT LIMITS

-  1.0 BENEFIT
-  0.25 BENEFIT

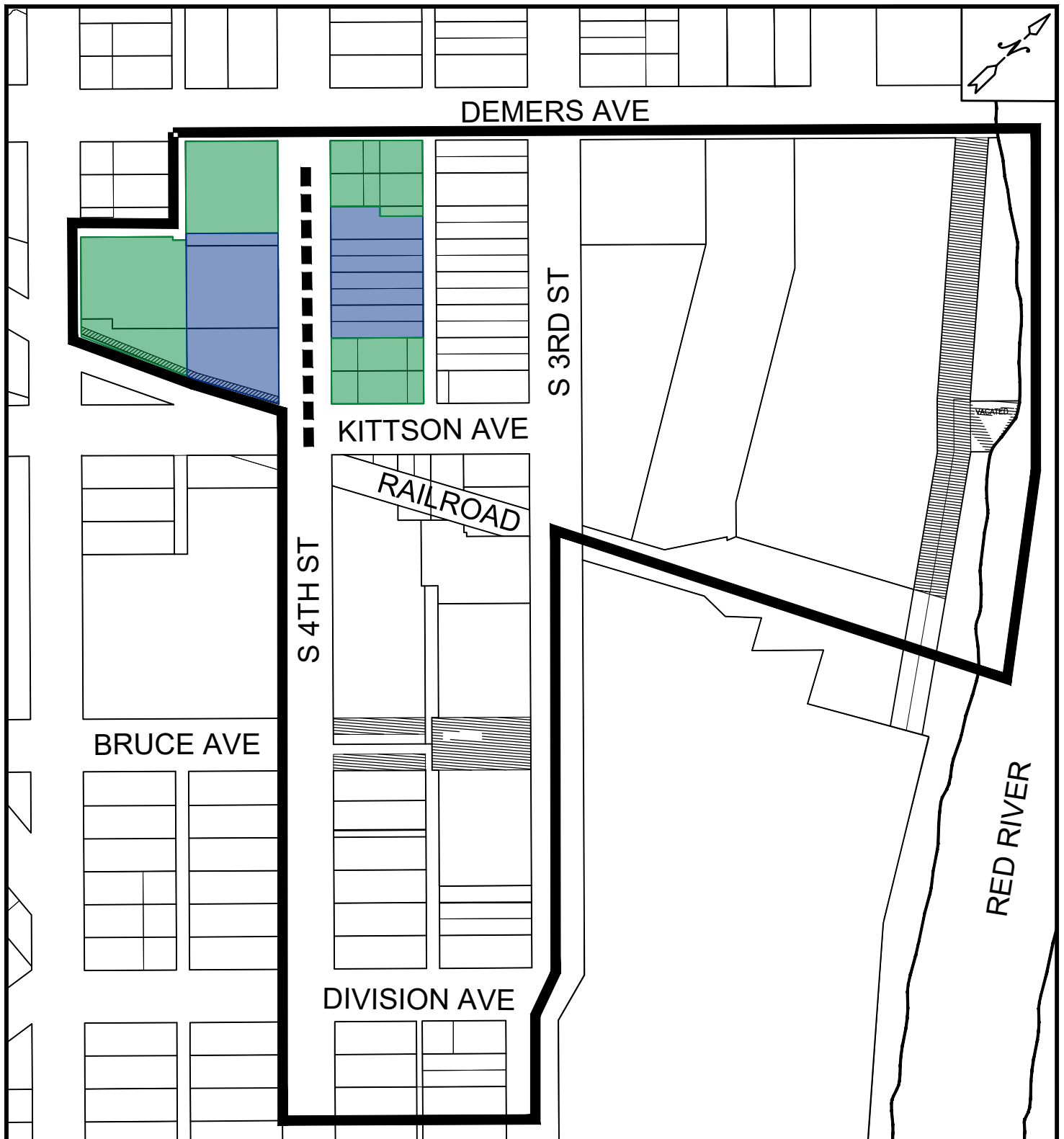

## 2025 MILL & OVERLAY

**S 3RD ST (KITTSON TO RR) S 4TH ST (DEMERS TO KITTSON) KITTSON AVE (S 3RD ST TO S 4TH ST)**

PROJECT # 8884.3

DISTRICT # 793.3

### LEGEND

- ASSESSMENT DISTRICT BOUNDARY
- PROJECT LIMITS
- 1.0 BENEFIT
- 0.25 BENEFIT

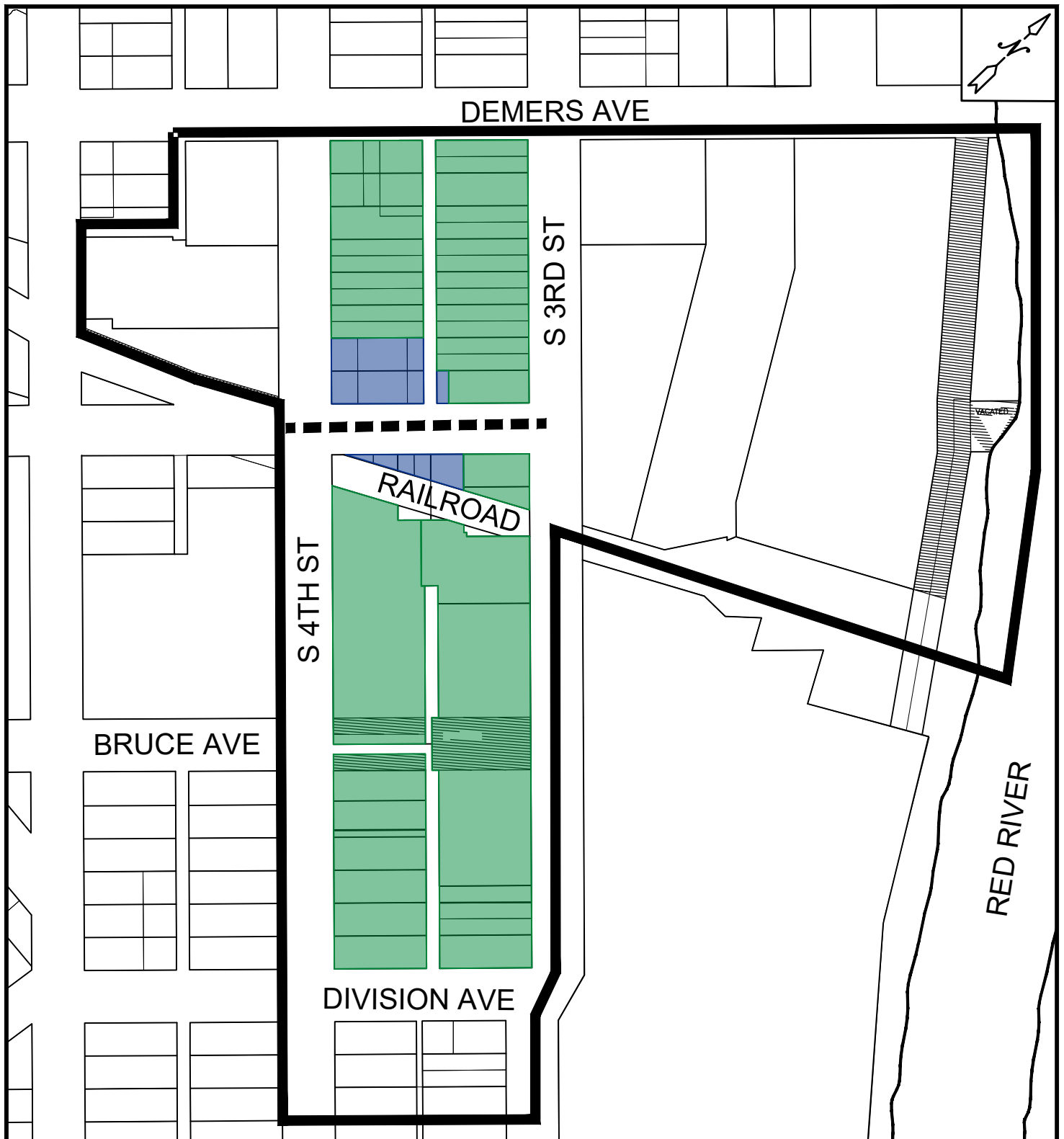

**2025 MILL & OVERLAY**

**S 3RD ST (KITTSOON TO RR) S 4TH ST (DEMERS TO KITTSOON) KITTSOON AVE (S 3RD ST TO S 4TH ST)**

PROJECT # 8884.3

DISTRICT # 793.3

LEGEND



ASSESSMENT DISTRICT BOUNDARY



PROJECT LIMITS



1.0 BENEFIT



0.25 BENEFIT

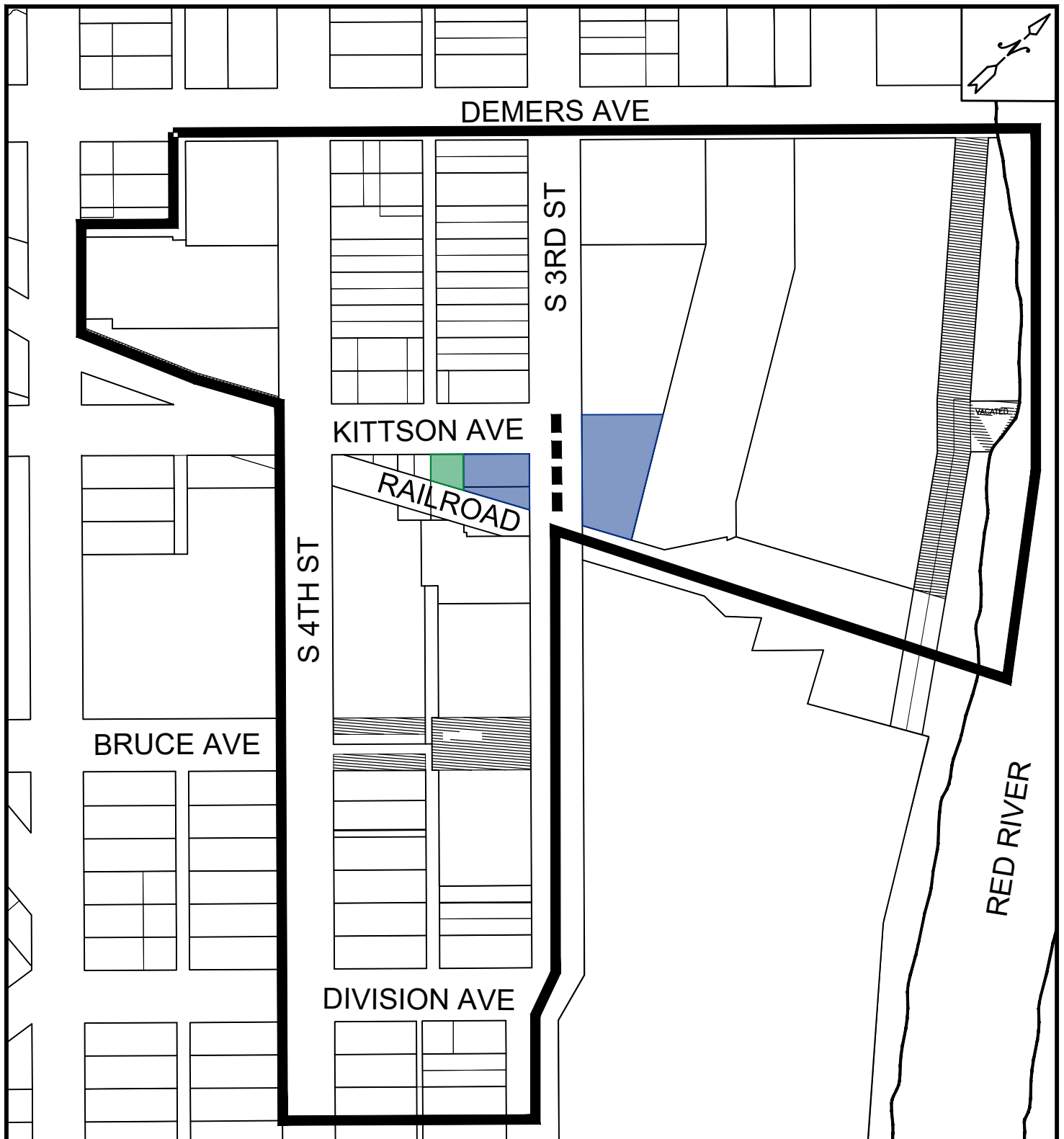

**2025 MILL & OVERLAY**

**S 3RD ST (KITTSON TO RR) S 4TH ST (DEMERS TO KITTSON) KITTSON AVE (S 3RD ST TO S 4TH ST)**

LEGEND

PROJECT # 8884.3

DISTRICT # 793.3



ASSESSMENT DISTRICT BOUNDARY



PROJECT LIMITS



1.0 BENEFIT



0.25 BENEFIT

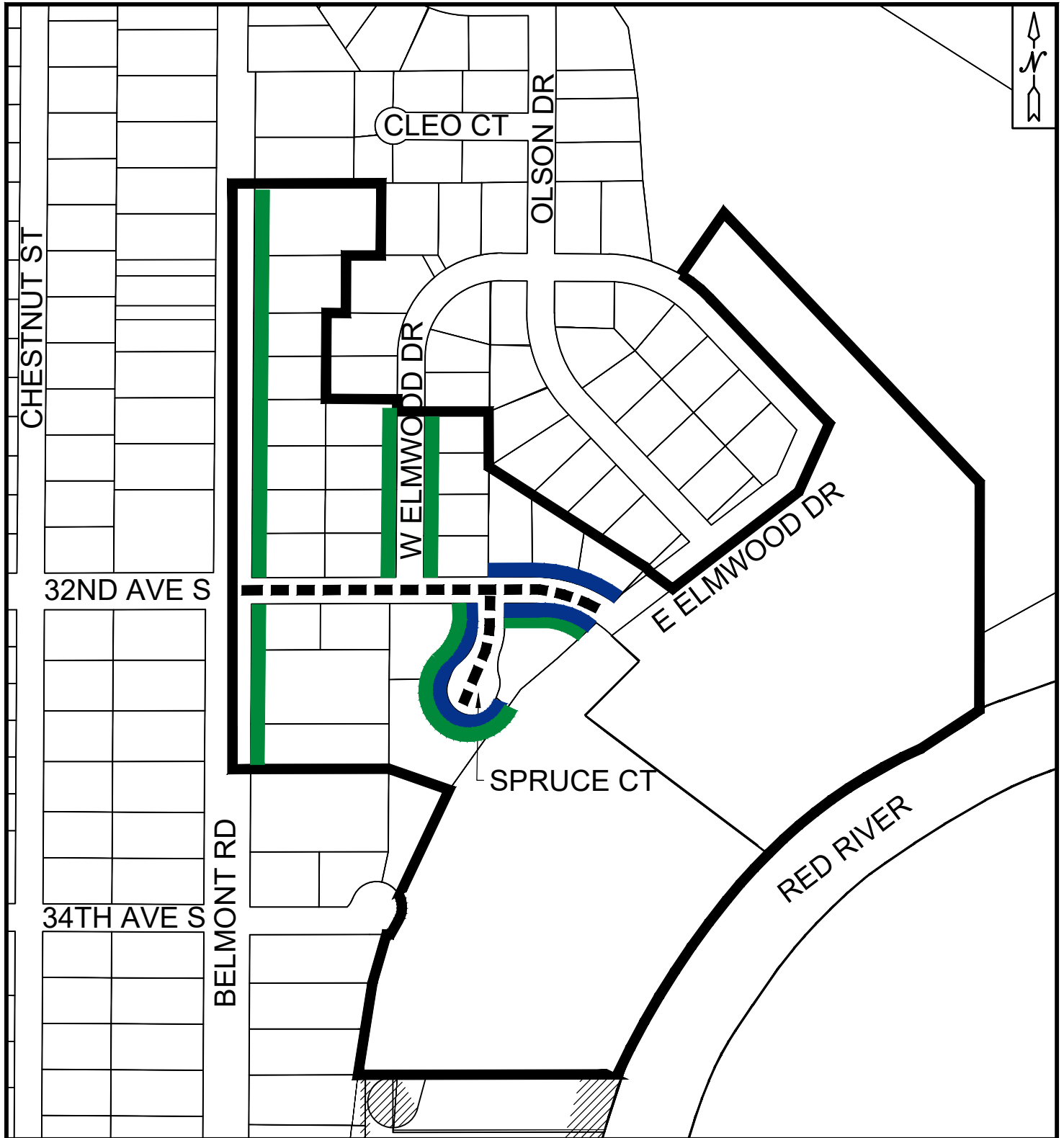

**2025 MILL & OVERLAY  
 SPRUCE CT & 32ND AVE S  
 (BELMONT RD TO E ELMWOOD DR)**

PROJECT # 8884.4  
 DISTRICT # 793.4

LEGEND

- ASSESSMENT DISTRICT BOUNDARY
- PROJECT LIMITS
- 1.0 FRONTAGE
- 0.33 SIDEAGE

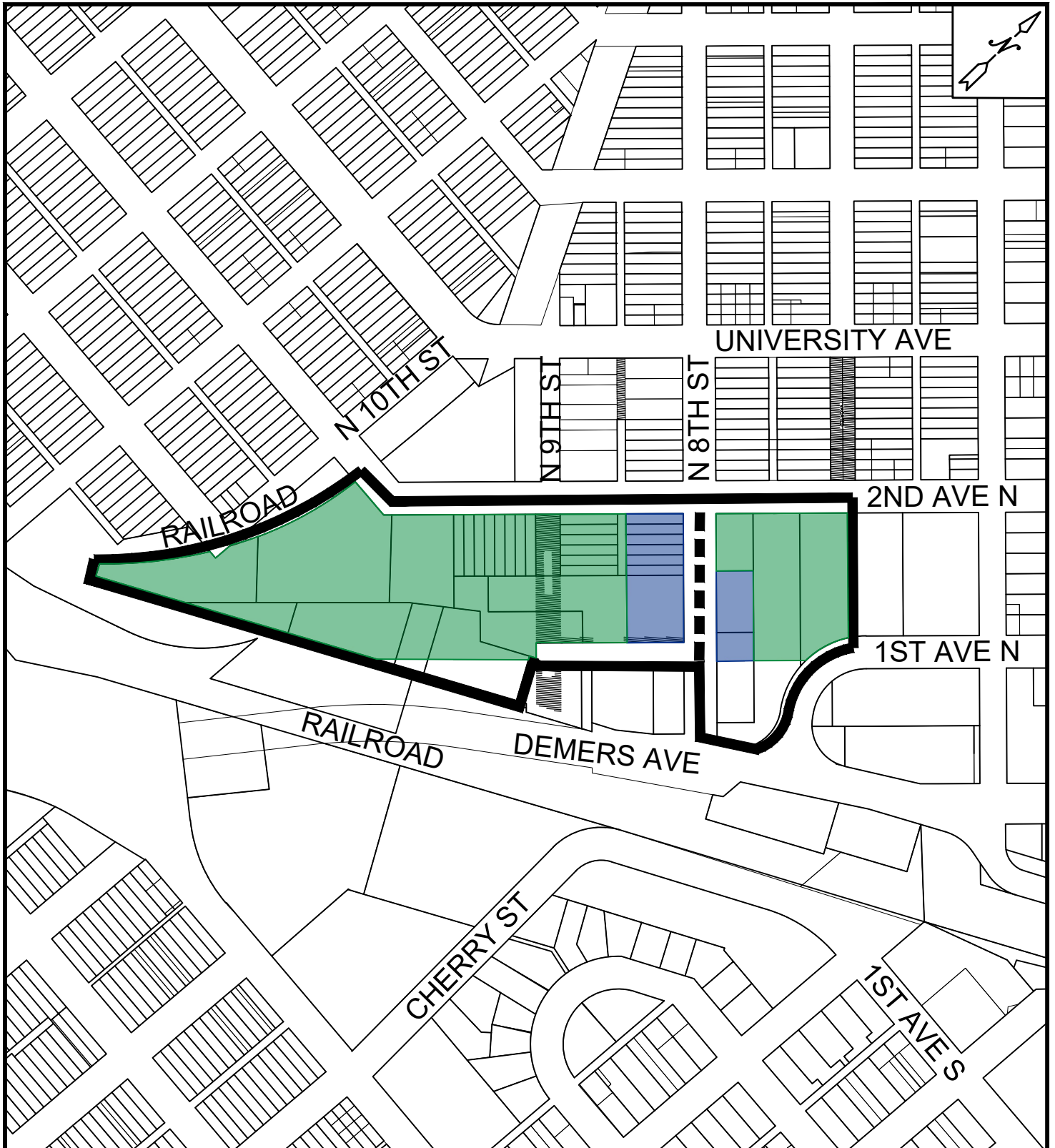

## 2025 MILL & OVERLAY N 8TH ST (1ST AVE N TO 2ND AVE N)

### LEGEND

- |                  |  |                              |  |              |
|------------------|--|------------------------------|--|--------------|
| PROJECT # 8884.5 |  | ASSESSMENT DISTRICT BOUNDARY |  | 1.0 BENEFIT  |
| DISTRICT # 793.5 |  | PROJECT LIMITS               |  | 0.25 BENEFIT |